



NOTES:

This Site Plan does not show widths or constructional details

Borough/Parish Boundary

Public Right of Way

KEY:

Classified Roads

Highway to be stopped up

Highway to be improved

New Highway

Private Means of Access to be stopped up

New Means of Access

(District of Vale of White Horse)

P01	First Issue	08/11/22	AH SS	JH
Rev	Description	Date	By Check	Approved

This map is reproduced from Ordnance Survey material with the permission of Ordnance Survey on behalf of the Controller of Her Majesty's Stationery Office. © Crown Copyright. Unauthorised reproduction infringes Crown Copyright and may lead to prosecution or civil proceedings. Oxfordshire County Council, 0100023343, 2021



THE OXFORDSHIRE COUNTY COUNCIL (DIDCOT
GARDEN TOWN HIGHWAYS INFRASTRUCTURE –
A4130 IMPROVEMENT (MILTON GATE TO COLLETT
ROUNDBOUT), A4197 DIDCOT TO CULHAM LINK
ROAD, AND A415 CLIFTON HAMPDEN BYPASS)
(SIDE ROADS) ORDER 2022

SITE PLAN 11 -

A4197 DIDCOT LINK ROAD – B4016 JUNCTION
IMPROVEMENTS, WEST OF APPLEFORD STATION

The COMMON SEAL of
Oxfordshire County Council
was hereunto affixed in the
presence of –

.....
Authorised Officer

Dated this 21st day of
December 2022

Seal No. 1494122

Drawn AH	Checked SS	Approved JH	Date 08/11/22
-------------	---------------	----------------	------------------

GH Project Number	Scale at A1
132861.001	1:1,000

Drawing Number	Revision
GH-132861001-SRO-11	P01

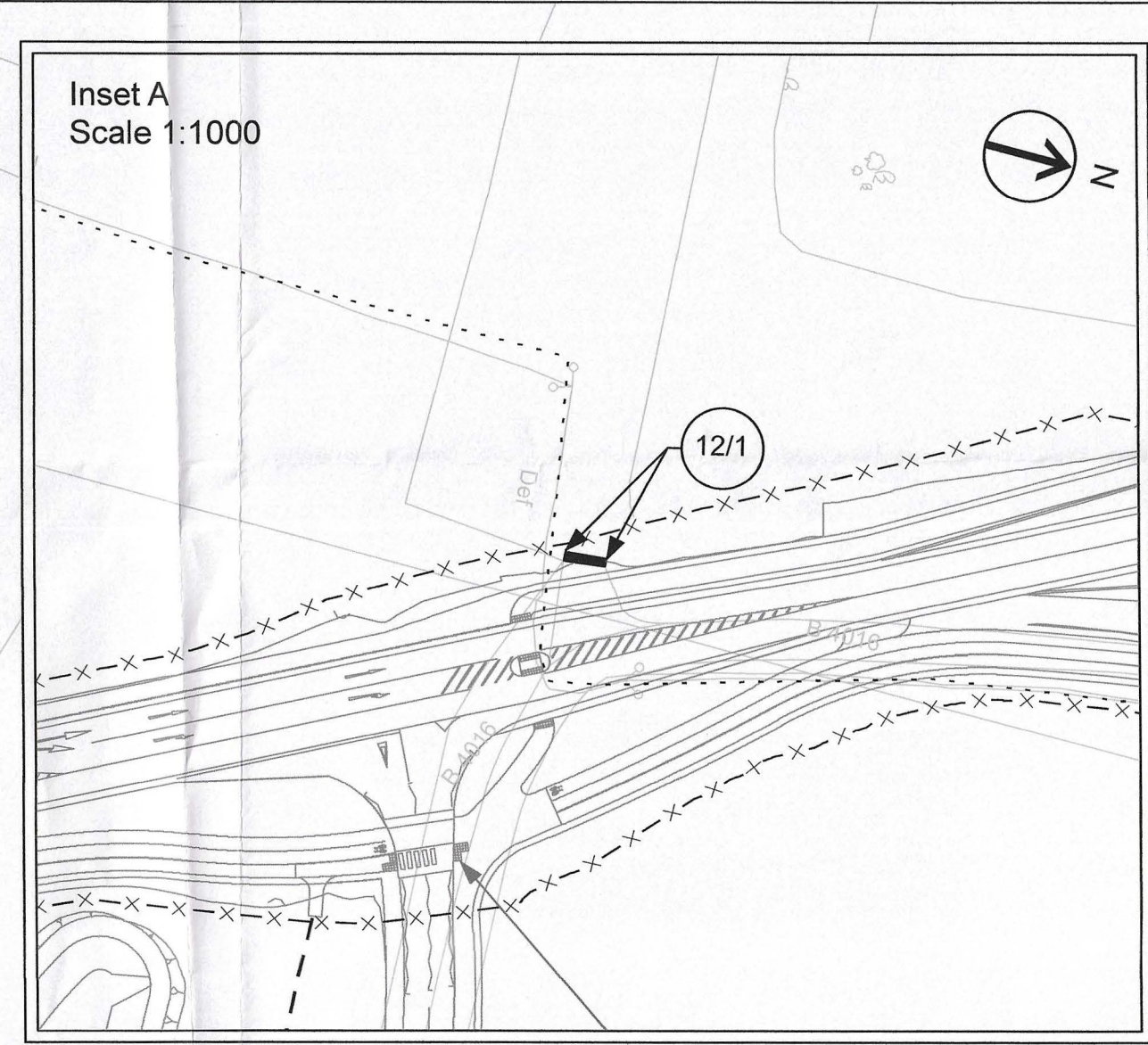
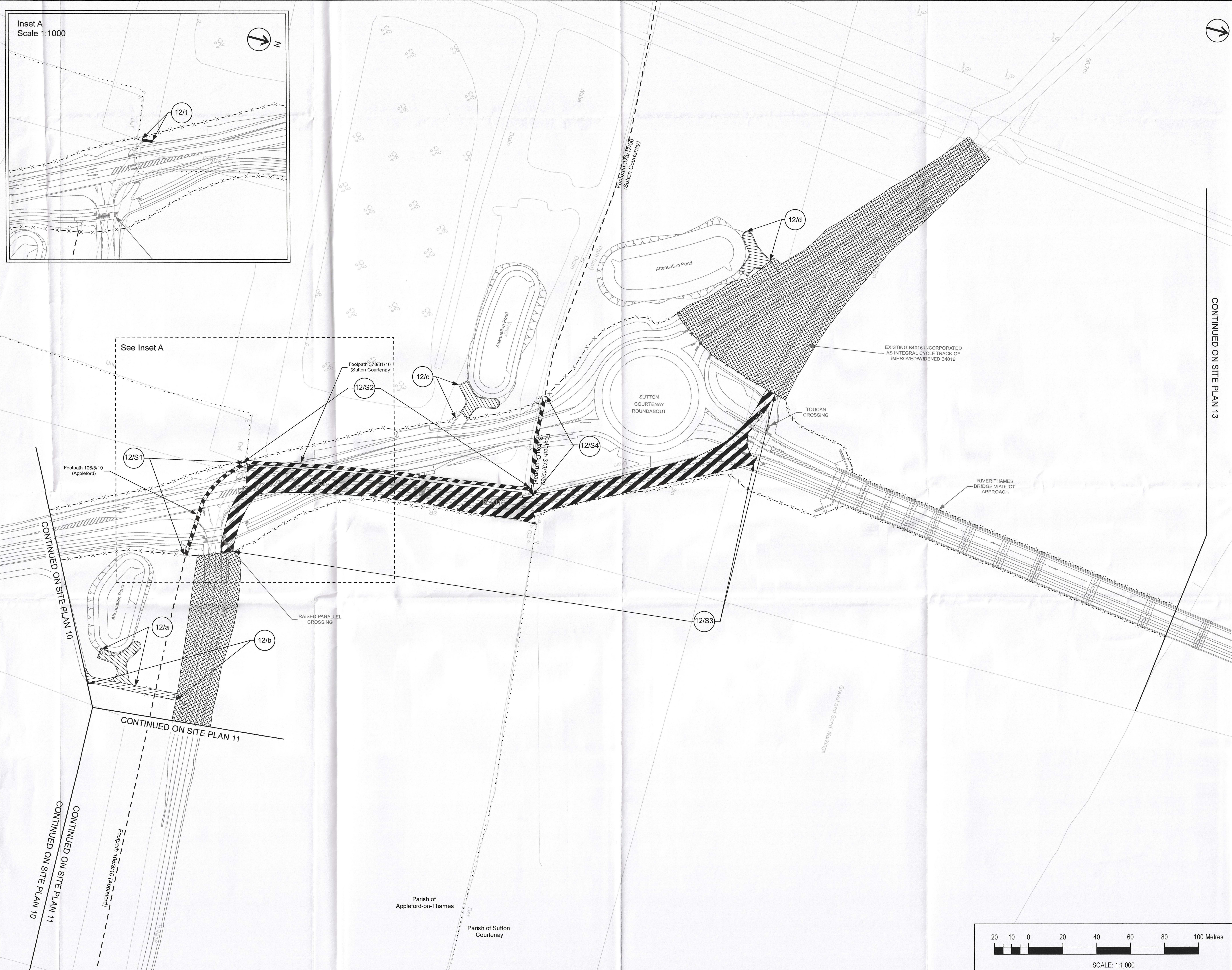

NOTES:
This Site Plan does not show widths or constructional details

Borough/Parish Boundary - - - - -
Public Right of Way - - - - -

KEY:

Classified Roads
Highway Boundary - - - - -
Highway Boundary - - - - -
Highway to be stopped up [Hatched pattern]
Highway to be improved [Cross-hatched pattern]
New Highway [Dotted pattern]
Private Means of Access to be stopped up [Solid black]
New Means of Access [Diagonal lines]

(District of Vale of White Horse)

P01	First Issue	08/11/22	AH	SS	JH
Rev	Description	Date	By	Check	Approved

This map is reproduced from Ordnance Survey material with the permission of Ordnance Survey on behalf of the Controller of Her Majesty's Stationery Office. © Crown Copyright. Unauthorised reproduction infringes Crown Copyright and may lead to prosecution or civil proceedings. Oxfordshire County Council, 0100023343, 2021

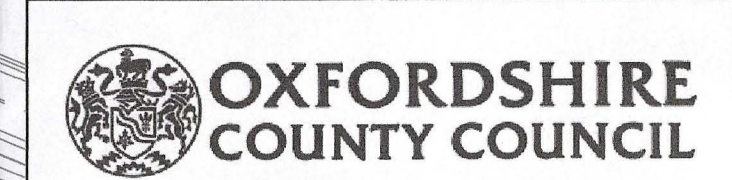

THE OXFORDSHIRE COUNTY COUNCIL (DIDCOT GARDEN TOWN HIGHWAYS INFRASTRUCTURE – A4130 IMPROVEMENT (MILTON GATE TO COLLETT ROUNDABOUT), A4197 DIDCOT TO CULHAM LINK ROAD, AND A415 CLIFTON HAMPDEN BYPASS) (SIDE ROADS) ORDER 2022

SITE PLAN 12 -
A4197 DIDCOT LINK ROAD – SOUTH OF B4016 TO SUTTON COURTNEY ROUNDABOUT TO RIVER THAMES CROSSING APPROACH

The COMMON SEAL of Oxfordshire County Council was hereunto affixed in the presence of –

Authorised Officer
Dated this 21st day of December 2022
Seal No. 1495122

Drawn	Checked	Approved	Date
AH	SS	JH	08/11/22

GH Project Number	Scale at A1
132861.001	1:1,000
Drawing Number	Revision
GH-132861001-SRO-12	P01

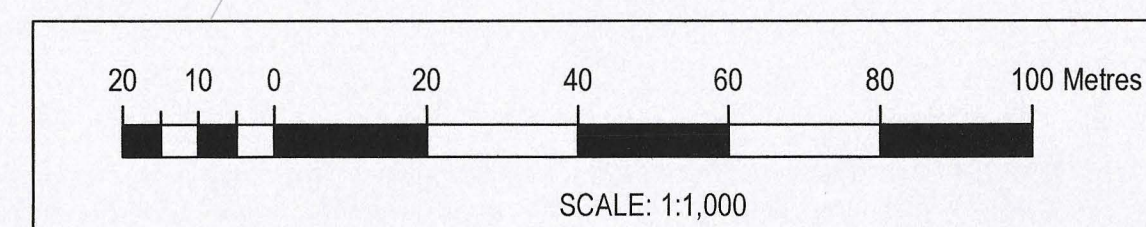

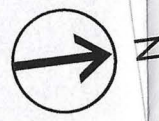

NOTES:

This Site Plan does not show widths or construction details

Borough/Parish Boundary - - - - -

Public Right of Way - - - - -

KEY:

Classified Roads

Highway Boundary - - - - -

Highway to be stopped up

Highway to be improved

New Highway

Private Means of Access to be stopped up

New Means of Access

(District of Vale of White Horse and District of South Oxfordshire)

P01	First Issue	08/11/22	AH	SS	JH
Rev	Description	Date	By	Check	Approved

This map is reproduced from Ordnance Survey material with the permission of Ordnance Survey on behalf of the Controller of Her Majesty's Stationary Office. © Crown Copyright. Unauthorised reproduction infringes Crown Copyright and may lead to prosecution or civil proceedings. Oxfordshire County Council, 0100023343, 2021

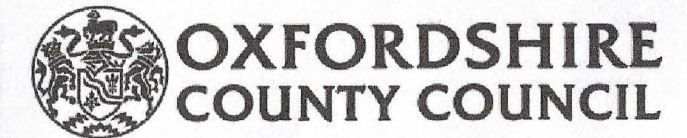

THE OXFORDSHIRE COUNTY COUNCIL (DIDCOT GARDEN TOWN HIGHWAYS INFRASTRUCTURE – A4130 IMPROVEMENT (MILTON GATE TO COLLETT ROUNDABOUT), A4197 DIDCOT TO CULHAM LINK ROAD, AND A415 CLIFTON HAMPDEN BYPASS) (SIDE ROADS) ORDER 2022

SITE PLAN 13 -
A4197 DIDCOT LINK ROAD – RIVER THAMES BRIDGE CROSSING

The COMMON SEAL of
Oxfordshire County Council
was hereunto affixed in the
presence of –

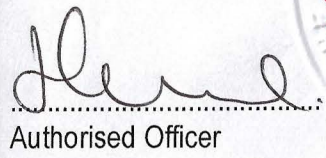
Authorised Officer

Dated this 21st day of December 2022 Seal No. 14.96/2.2

Drawn	Checked	Approved	Date
AH	SS	JH	08/11/22

GH Project Number
132861.001

Scale at A1
1:1,000

Drawing Number
GH-132861001-SRO-13

Revision
P01

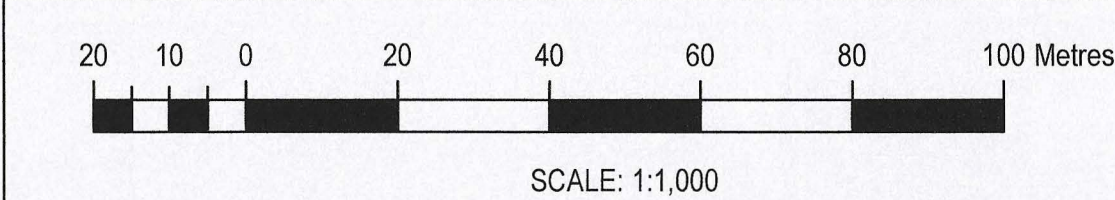

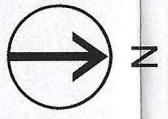

NOTES:
This Site Plan does not show widths or constructional details

Borough/Parish Boundary - - - - -

Public Right of Way - - - - -

KEY:

Classified Roads

Highway Boundary

Highway to be stopped up

Highway to be improved

New Highway

Private Means of Access to be stopped up

New Means of Access

(District of South Oxfordshire)

P01	First Issue	06/11/22	AH	SS	JH
Rev	Description	Date	By	Check	Approved

This map is reproduced from Ordnance Survey material with the permission of Ordnance Survey on behalf of the Controller of Her Majesty's Stationary Office. © Crown Copyright. Unauthorised reproduction infringes Crown Copyright and may lead to prosecution or civil proceedings. Oxfordshire County Council, 0100023343, 2021

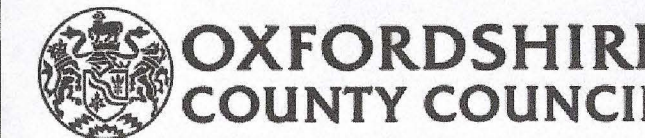

THE OXFORDSHIRE COUNTY COUNCIL (DIDCOT GARDEN TOWN HIGHWAYS INFRASTRUCTURE – A4130 IMPROVEMENT (MILTON GATE TO COLLETT ROUNDABOUT), A4197 DIDCOT TO CULHAM LINK ROAD, AND A415 CLIFTON HAMPDEN BYPASS) (SIDE ROADS) ORDER 2022

SITE PLAN 14 -
A4197 DIDCOT LINK ROAD – RIVER THAMES BRIDGE CROSSING TO A415 ABINGDON ROAD ROUNDABOUT

The COMMON SEAL of
Oxfordshire County Council
was hereunto affixed in the
presence of –



[Signature]
Authorised Officer

Dated this 21st day of December 2022 Seal No. 14/17/22

Drawn	Checked	Approved	Date
AH	SS	JH	08/11/22

GH Project Number	Scale at A1
132861.001	1:1,000

Drawing Number	Revision
GH-132861001-SRO-14	P01

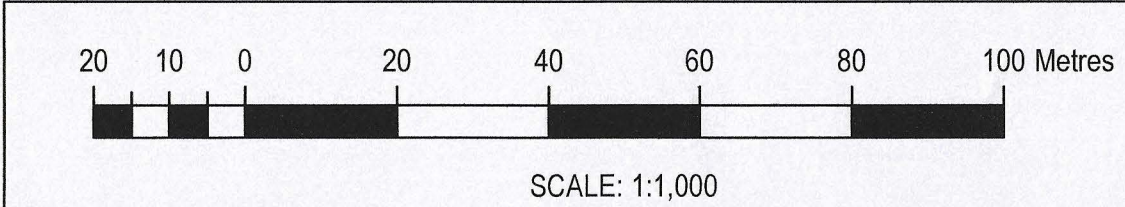

CONTINUED ON SITE PLAN 15

CONTINUED ON SITE PLAN 13

NEW FIELD ACCESS

14/b

NEW PRIVATE ACCESS TO ZOUCHE FARM BUILDINGS

14/a

RAISED TABLE

ZOUCHE FARM BARN

Track

Existing A415 incorporated within improved/widened A415

14/1

14/2

TOUCAN CROSSING

Existing A415 incorporated within improved/widened A415

50.8m

ABINGDON ROUNDABOUT

Attenuation Pond

RAISED PARALLEL CROSSING

LINK TO FUTURE DEVELOPMENT AREA

14/c

14/d

Parish of Culham

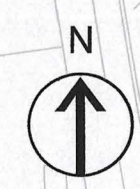

NOTES:
This Site Plan does not show widths or constructional details

Borough/Parish Boundary - - - - -

Public Right of Way - - - - -

KEY:

Classified Roads

Highway Boundary

Highway to be stopped up

Highway to be improved

New Highway

Private Means of Access to be stopped up

New Means of Access

(District of South Oxfordshire)

CONTINUED ON SITE PLAN 14

CONTINUED ON SITE PLAN 16

P01	First Issue	08/11/22	AH	SS	JH
Rev	Description	Date	By	Check	Approved

This map is reproduced from Ordnance Survey material with the permission of Ordnance Survey on behalf of the Controller of Her Majesty's Stationery Office. © Crown Copyright. Unauthorised reproduction infringes Crown Copyright and may lead to prosecution or civil proceedings. Oxfordshire County Council, 0100623343, 2021

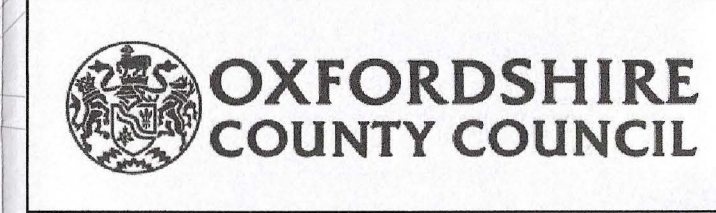

THE OXFORDSHIRE COUNTY COUNCIL (DIDCOT GARDEN TOWN HIGHWAYS INFRASTRUCTURE – A4130 IMPROVEMENT (MILTON GATE TO COLLETT ROUNDABOUT), A4197 DIDCOT TO CULHAM LINK ROAD, AND A415 CLIFTON HAMPDEN BYPASS) (SIDE ROADS) ORDER 2022

SITE PLAN 15 -
A415 IMPROVEMENT- ABINGDON ROAD ROUNDABOUT TO CULHAM STATION

The COMMON SEAL of Oxfordshire County Council was hereunto affixed in the presence of -

Authorised Officer

Dated this 21st day of December 2022

Seal No. 14.98/2.2

Drawn	Checked	Approved	Date
AH	SS	JH	08/11/22
GH Project Number		Scale at A1	
132861.001		1:1,000	
Drawing Number			Revision
GH-132861001-SRO-15			P01

