

Official copy of register of title

Title number NN85772

Edition date 02.07.2015

- This official copy shows the entries on the register of title on 07 Jul 2015 at 12:35:05.
- This date must be quoted as the "search from date" in any official search application based on this copy.
- The date at the beginning of an entry is the date on which the entry was made in the register.
- Issued on 07 Jul 2015.
- Under s.67 of the Land Registration Act 2002, this copy is admissible in evidence to the same extent as the original.
- This title is dealt with by Land Registry Leicester Office.

A: Property Register

This register describes the land and estate comprised in the title.

NORTHAMPTONSHIRE : WELLINGBOROUGH

- 1 (05.03.1986) The Freehold land shown edged with red on the plan of the above Title filed at the Registry and being land on the south side of Irthlingborough Road, Wellingborough.
- 2 The land has the benefit of the rights granted by a Conveyance of the land in this title dated 28 February 1986 made between (1) Anglian Water Authority and (2) Northamptonshire County Council.

NOTE: Original filed.

- 3 The Conveyance dated 28 February 1986 referred to above contains an agreement as to an access road.
- 4 (20.11.1992) A new filed plan based on the latest revision of the Ordnance Survey Map has been substituted for the original plan.

B: Proprietorship Register

This register specifies the class of title and identifies the owner. It contains any entries that affect the right of disposal.

Title absolute

- 1 (02.07.2015) PROPRIETOR: BOVIS HOMES LIMITED (Co. Regn. No. 397634) of The Manor House, North Ash Road, New Ash Green, Longfield DA3 8HQ.
- 2 (02.07.2015) The price stated to have been paid on 10 June 2015 was £240,000.

C: Charges Register

This register contains any charges and other matters that affect the land.

- 1 A Wayleave Consent dated 27 July 1960 in favour of East Midlands Electricity Board relates to placing of an overhead electric line stays and legs in the position shown by a blue broken line on the filed plan so far as it affects the land in this title.

Title number NN85772

C: Charges Register continued

NOTE: Copy filed.

End of register

H.M. LAND REGISTRY

TITLE NUMBER
NN85772



ORDNANCE SURVEY
PLAN REFERENCE SP9067

SECTION E

SCALE
1/2500

ADMINISTRATIVE AREA Northamptonshire : Wellingborough

The boundaries shown by dotted lines have been plotted from the plans on the deeds. The title plan may be updated from later survey information

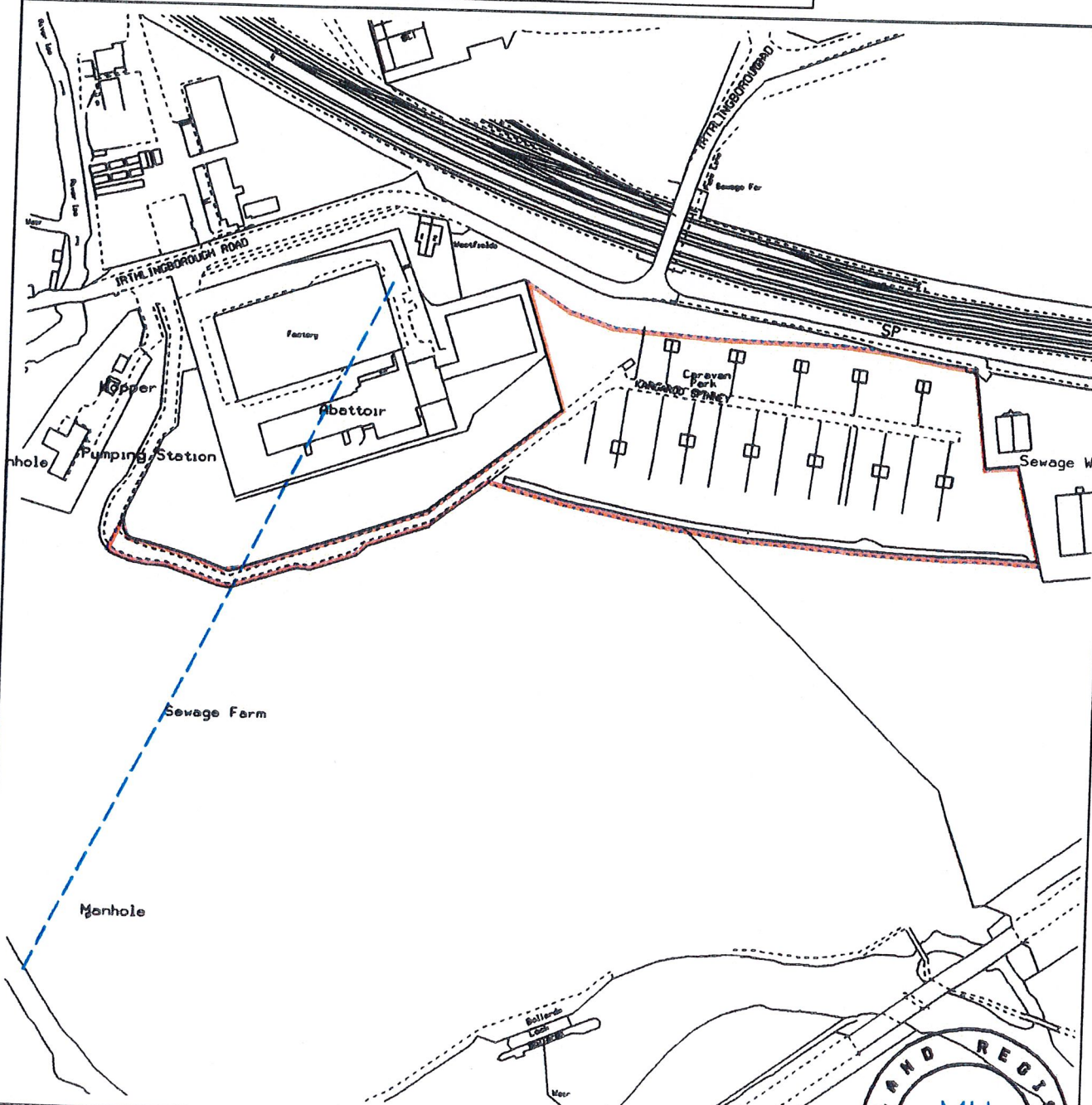

This plan is based on the largest scale of the published Ordnance Survey map.
Crown Copyright. Produced by HMLR. Further reproduction in whole or in part is
prohibited without the prior written permission of Ordnance Survey. Licence No GD272728.



This official copy is incomplete without the preceding notes page.

000017