

Transport and Works Act 1992

The Network Rail (Cambridgeshire Level Crossing Reduction) Order

COUNTY OF CAMBRIDGESHIRE, DISTRICT OF EAST CAMBRIDGESHIRE
PARISH OF ELY

Replacement Sheet 10
C24 - Cross Keys
Level Crossing

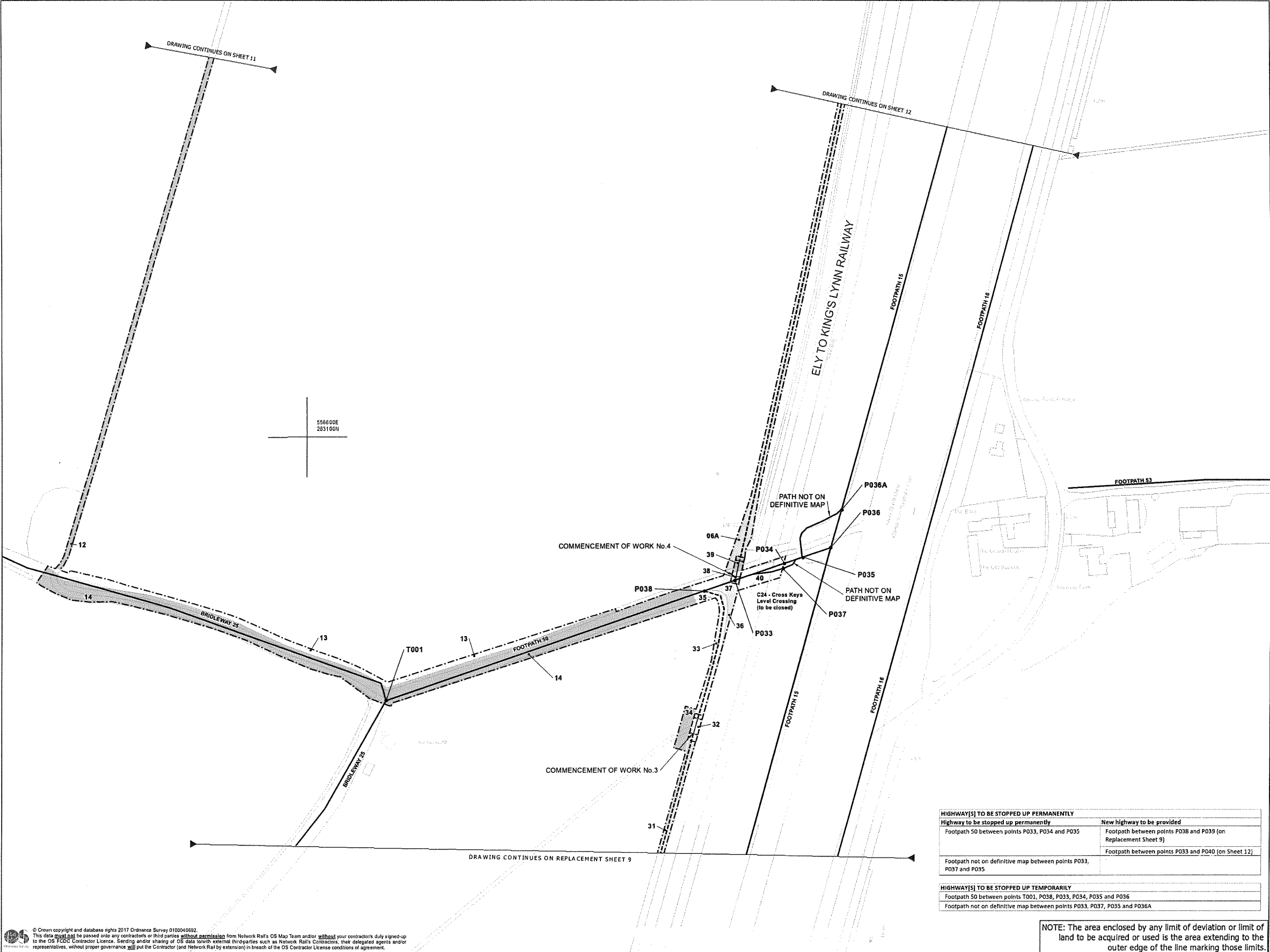

PLAN

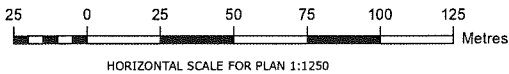

© Crown copyright and database rights 2017 Ordnance Survey 0100040692.
This data must not be passed on to any third parties without permission from Network Rail's OS Map Team and/or your contractor's duly signed-up to the OS FOD Contractor Licence. Sending and/or sharing of OS data to third parties such as Network Rail's Contractors, their delegated agents and/or representatives, without proper governance will put the Contractor (and Network Rail by extension) in breach of the OS Contractor Licence conditions of agreement.