

The Network Rail (Suffolk Level Crossing Reduction) Order ("Order")

Order modification request in relation to crossing S29 Hawk End Lane

1. The draft Order includes powers to acquire rights over and temporarily occupy plots 11, 12 and 13 in the Parish of Elmswell ("the plots") shown on Sheet 13 of the Order plans.
2. The plots are located on the property of Taylor Wimpey UK Limited (Taylor Wimpey).
3. Network Rail and Taylor Wimpey entered into an agreement dated 8 May 2018 ("agreement") whereby Network Rail has agreed to submit a written request to the Inspector seeking a modification to the draft Order by withdrawing the plots.
4. The replacement Sheet 13 without the plots is attached.
5. Network Rail shall submit the amended filled up Order with the plots deleted from Schedule 4 (plot 13) and Schedule 5 (plots 11 and 12) as set out below, together with other (unconnected) modifications sought by Network Rail, for the order modification session in week 7 of the inquiry commencing on 21 May.

Please note that the deleted plots marked with * in the extracted tables below relate to earlier modifications unconnected to the agreement.

Extract from Schedule 4 to the Order (*Land in which only new rights etc, may be acquired*)

(1) Area	(2) Number of land shown on the deposited plans	(3) Purpose for which rights may be acquired
Parish of Elmswell	13, 15, 16, 19, 20, 21, 22, 23, 24, 25*	Access for creation of public right of way Access for removal of level crossing

Extract from Schedule 5 to the Order (*Land of which temporary possession may be taken*)

(1) Area	(2) Number of land shown on the land plans	(3) Purpose for which temporary possession may be taken
Parish of Elmswell	01, 04, 05, 06, 17, 18	Creation of public right of way
	08	Access for removal of level crossing
	11, 12, 14, 26*, 27, 28, 29, 31, 32, 33, 34	Worksite

10 May 2018

Transport and Works Act 1992
Suffolk Level Crossing
COUNTY OF SUFFOLK, DISTRICT OF MID SUFFOLK
PARISH OF ELMSWELL

Transport and Works Act 1992

The Network Rail (Suffolk Level Crossing Reduction) Order

COUNTY OF SUFFOLK, DISTRICT OF MID SUFFOLK

PARISH OF ELMSWELL

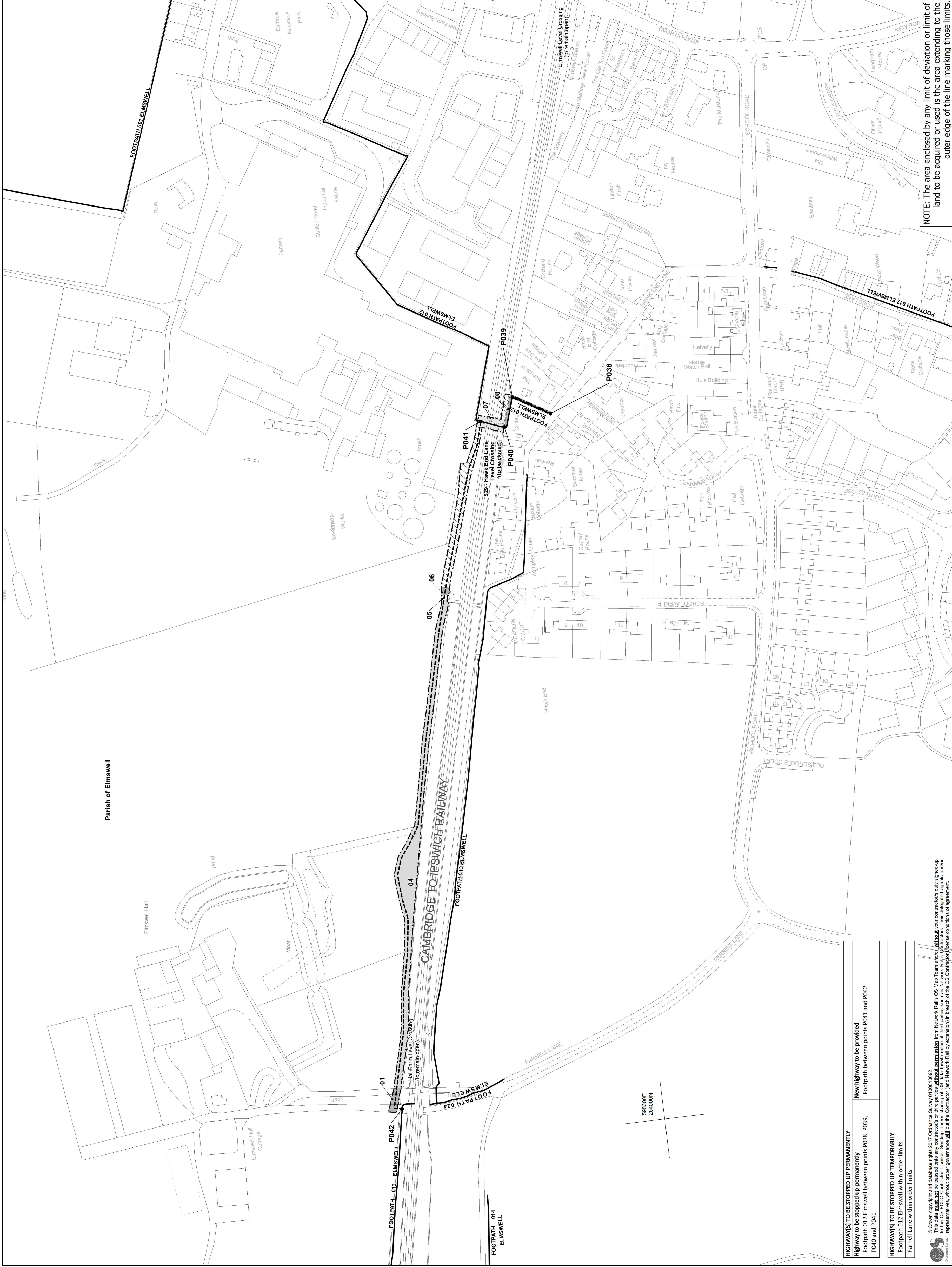

PLAN

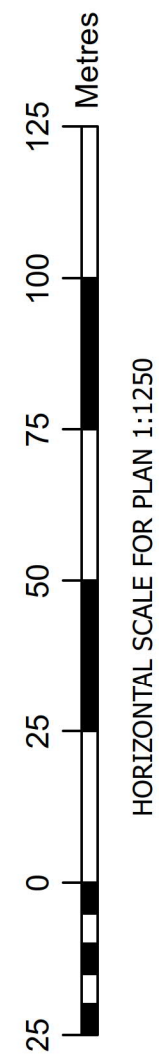

HORIZONTAL SCALE FOR PLAN 1:1250