

~~OBJ/Sec/40/1~~
OP-INQ-47

TRANSPORT AND WORKS ACT 1992
APPLICATION FOR THE PROPOSED NETWORK RAIL
(SUFFOLK LEVEL CROSSING REDUCTION) ORDER

WRITTEN STATEMENT OF CASE (Revision 2)

REFERENCE – TWA/17/APP/04/OBJ/40

PREPARED BY

SIMON GOODERHAM MRICS FAAV

(Agent on behalf of C C Gooderham & Son)

13th MARCH 2018

- 1.0 I represent and act for C C Gooderham and Son who are the freehold owners of the land known as Brickwall Field lying to the west of level crossing S69.

PROPOSED CLOSURE OF PUBLIC FOOTPATH 13 & LEVEL CROSSING S69 BACTON

- 2.0 The objection relates to the closure of public footpath 13 which passes over level crossing S69 Bacton. The objection was first raised in email correspondence dated 4th May 2017 following the service of Notice 413 on the landowners.
- 3.0 Since the objection was raised there has been no consultation with the stakeholders or landowners in relation to the proposed closure of crossing S69, or the wider proposals regarding the proposed alternative arrangements for the public footpath network in around the village of Bacton.
- 4.0 A copy of the letter from Network Rail dated 20 December 2017 has been received in response to the objection, which outlines the proposed alternative route and works to provide pedestrian access to Bacton Football Club in the event that S69 Bacton is closed.
- 5.0 The proposed alternative route is over 3.5 times longer in length (945m rather than 265m) than the existing pedestrian access, and 270m of the proposed new route is along the B1113 which has no street lighting or footways. A significant section of the new route is also in the 40 mph zone.
- 6.0 The proposed new access route along the B1113 would require pedestrians to either walk on the highway or along uneven and narrow grass verges which are totally inadequate for pedestrian use. The proposed works along this section of highway indicate that a new footway will be considered as part of the detailed design however there has been no firm commitment made to the provision of this.
- 7.0 There has been no detail provided regarding the dates when the 9-day camera census was actually undertaken and therefore it is not possible to establish whether the results of this census are a representative sample of the use of footpath 13. The physical evidence on the ground would suggest a greater use than 3 people per day as suggested by the camera census.
- 8.0 It is considered that the submitted proposal does not provide a suitable alternative pedestrian route to Bacton Football Club, due to the significantly increased length of the route and the limited detail relating to the provision of a footway for the full length of the new route.

- 9.0 The landowners, C C Gooderham, would be prepared to discuss making land available for an alternative route to utilise the old underpass which passes under the railway the south of S69. This underpass (marked X on Plan A) has currently been stopped up and replaced with a large culvert however consideration should be given to re-opening the underpass as an alternative the current proposals. The proposed alternative route is shown marked in a dashed blue line on attached Plan A.
- 10.0 Further consultation should be undertaken with stakeholders to discuss the extent of use of the existing footpath 13 and crossing S69 Bacton, and the proposed alternative route.
- 11.0 Based on the responses received to the objection to date Obj/40/SUFF/R001 is not withdrawn and further considering should be given to the alternative route suggested in 9.0.

PROPOSED CREATION OF NEW FOOTPATH BETWEEN POINTS P070, P071, P072 & P073

- 12.0 The objectors previously supported the creation of a new permanent footpath between points P070, P071, P072 and P073 shown on Sheet 21 of the Order plans and the associated new footbridge.
- 13.0 Since the original statement of support for this new footpath concerns have now been raised in relation to creation of part of this new footpath between points P072 and P073 and the extent of the proposed new footbridge. The proposed design of the new footbridge would extend significantly into Pulhams Lane and restrict vehicular access along Pulhams Lane to the landowners adjoining agricultural land. This is a particular concern in relation to the use of Pulhams Lane for agricultural vehicles which is the only route of access to farmland to the south.
- 14.0 It has further come to light that there is already an established footpath providing a pedestrian link from the residential properties at Birch Avenue, Pretyman Avenue, Cedar Close and Ash Close to the allotments and Bacton Primary school. This existing footpath is shown marked with a red dashed line on attached Plan B and is known as 'The Bracknells'. The path is a publicly maintainable highway, at footway status, and is registered in the County Council's List of Streets, edition published on 1 March 2018, and described as '*Church Road Footway Unassociated 0.11km NG25503999*'.
- 15.0 In view of the existing footway known as The Bracknells, together with concerns over restrictions to vehicular access along Pulhams Lane that will result from the proposed creation of the new footbridge, support for the new footpath between P072 and P073 is withdrawn.

SUMMARY & CONCLUSION

- 16.0 The objection Obj/40/SUFF/R001 to closure of footpath 13 and crossing S69 is not withdrawn. The alternative route that has been suggested for pedestrian access to Bacton Football Club does not provide a safe solution and will result in a considerably increased length of route along a main carriageway with no detail on the provision of footways. Before a final decision is made on the closure of crossing S69, further consideration and costings should be provided for re-opening the underpass to ensure a continued and safe pedestrian access from the village centre to the football club.
- 17.0 The original support for creation of a new footpath between P072 and P073 is withdrawn as the existing footpath known as *'The Bracknells'* already provides a well established pedestrian access to the school, allotments and doctors surgery. The proposed is no longer considered to be a necessary new link and the creation of the new footbridge as designed would prevent access for the agricultural vehicles to the adjoining farmland.

END

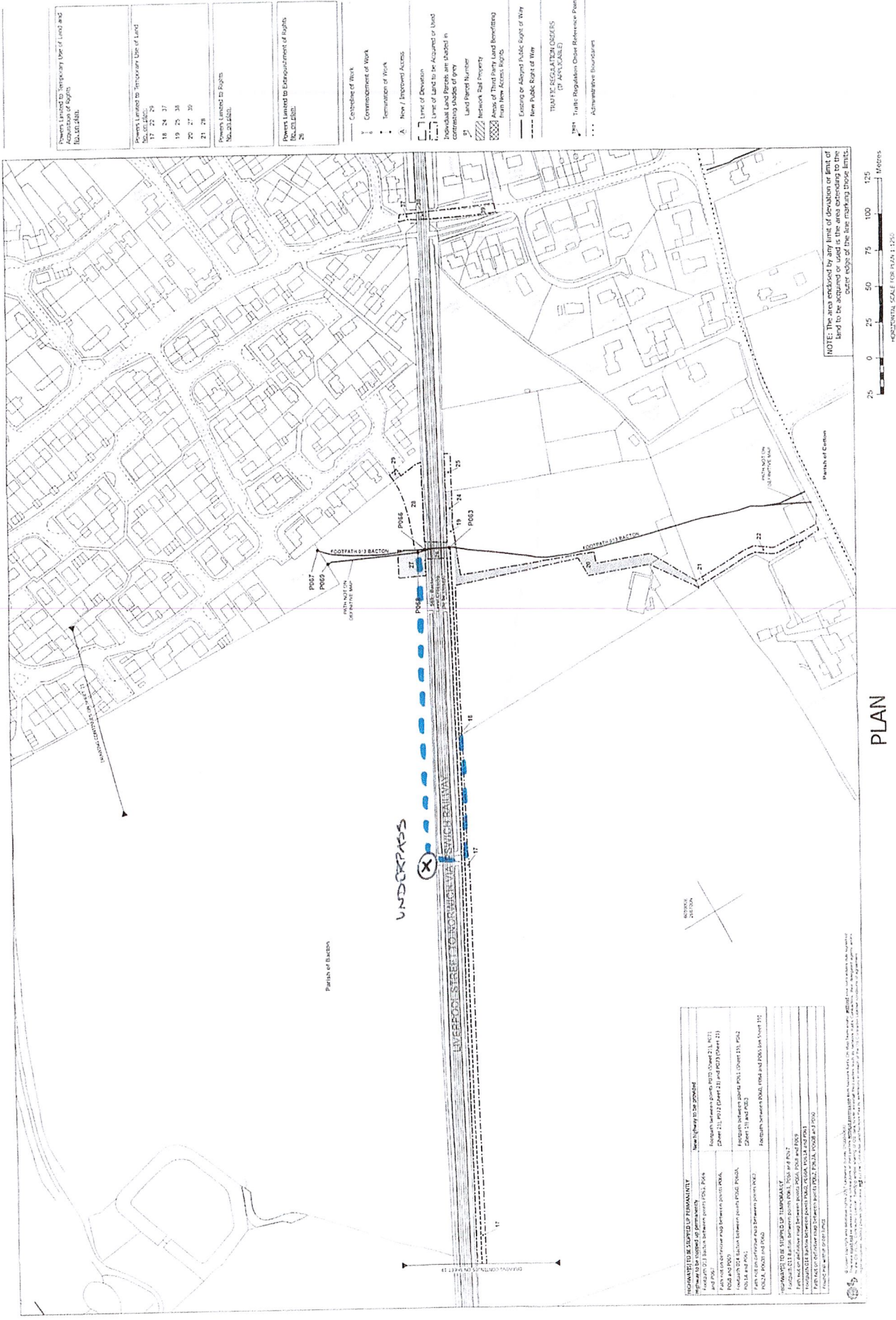

Transport and Works Act 1992
The Network Rail (Suffolk Level Crossing Reduction) Order
COUNTY OF SUFFOLK, DISTRICT OF MID SUFFOLK
PARISH OF BACTON

Sheet 21
569 - Bacton
Level Crossing

PLAN 3

