



© J.C.White Geomatics Limited
Copyright and other intellectual property rights in this drawing remain the property of
J.C.White Geomatics Limited. The plans may not be copied, used or passed to any third party
for any other purpose without the express consent of J.C.White Geomatics Limited.

Reproduced from Ordnance Survey Data © Crown Copyright July 2013
All Rights reserved. Licence Number 100020449.

124200mN

124000mN

123800mN

- GPS surveys
- setting out
- volumetric surveys
- boundary disputes
- topographical surveys
- engineering surveys
- measured building surveys
- deformation & settlement surveys

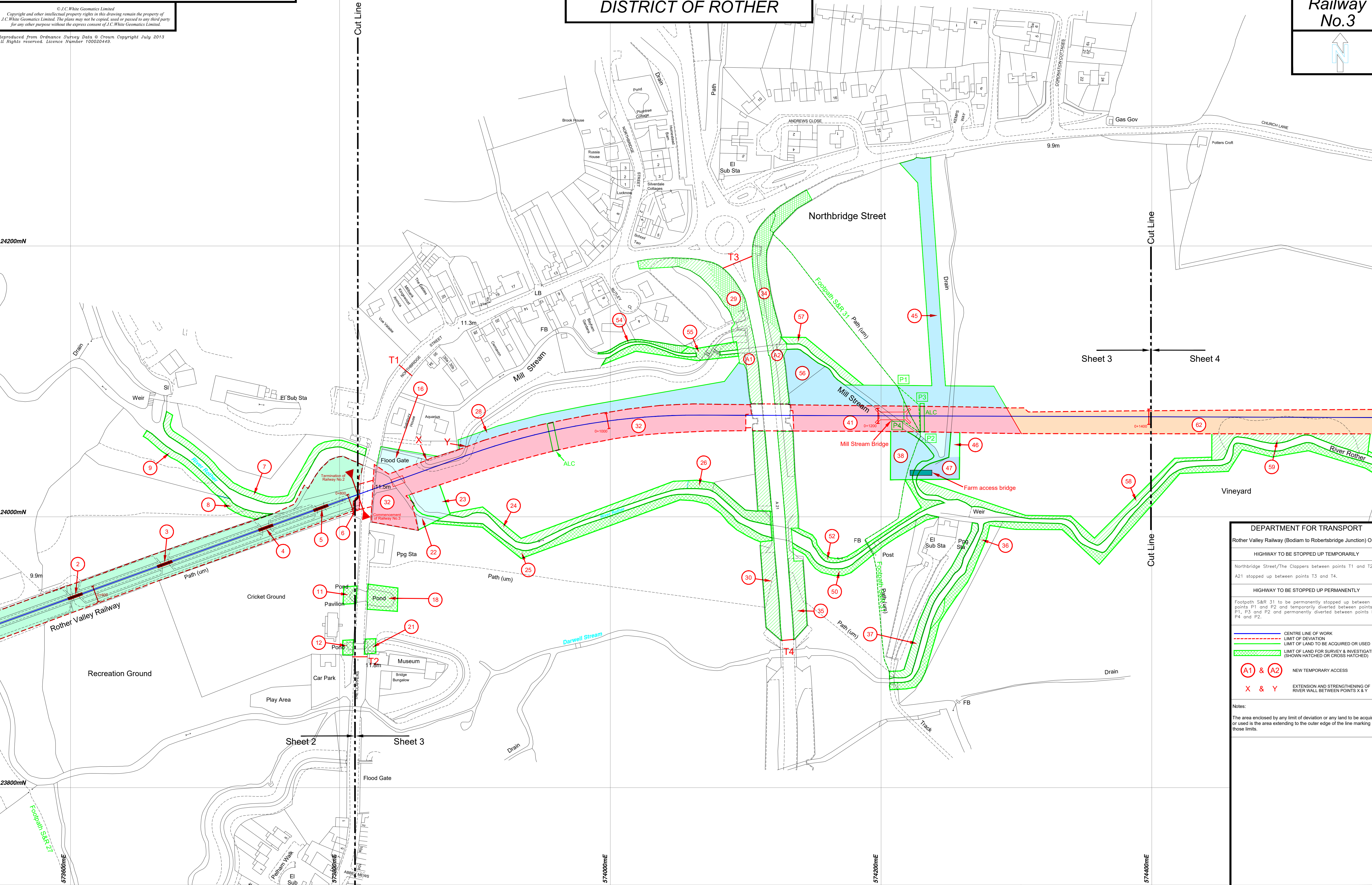

DEPARTMENT FOR TRANSPORT
Rother Valley Railway (Bodiam to Robertsbridge Junction) Order

HIGHWAY TO BE STOPPED UP TEMPORARILY
Northbridge Street/The Clappers between points T1 and T2.
A21 stopped up between points T3 and T4.

HIGHWAY TO BE STOPPED UP PERMANENTLY
Footpath S&R 31 to be permanently stopped up between points P1 and P2 and temporarily diverted between points P1, P3 and P2 and permanently diverted between points P1, P4 and P2.

LEGEND
CENTRE LINE OF WORK
LIMIT OF DEVIATION
LIMIT OF LAND TO BE ACQUIRED OR USED
LIMIT OF LAND FOR SURVEY & INVESTIGATION (SHOWN HATCHED OR CROSS HATCHED)

NEW TEMPORARY ACCESS
A1 & A2

EXTENSION AND STRENGTHENING OF RIVER WALL BETWEEN POINTS X & Y
X & Y

Notes:
The area enclosed by any limit of deviation or any land to be acquired or used is the area extending to the outer edge of the line marking those limits.