

Brenda Taplin

Subject: FW: RVR Inquiry
Attachments: Annex A to Obj 729.odt

From: Nicholas Moor >
Sent: 27 July 2021 13:34
To: Brenda Taplin <Brenda.Taplin@gateleyhamer.com>
Subject: RVR Inquiry

Good Afternoon Brenda,

Please find the attached Annex A to OBJ/729 that I presented to the Inquiry this morning.

The Inspector asked that I measure the height of the pavilion which I have done, the height from ground level to the base of the steel framed door is 126cm.

I believe that the Inspector will be starting his tour of the railway from the car park next to the Cricket Ground tomorrow afternoon at 1300hrs. If it would be useful for him to have access to the ground, the pavilion and survey the three culverts under the Clappers please let me know and I can be there to unlock for him.

Many Thanks and Stay Well
Yours Aye
Nick

Nicholas WF Moor
for and on behalf of
Robertsbridge Cricket Club



Virus-free. www.avast.com



in the County of Sussex Farmer and cattle Dealer (hereinafter called the one part) and Bruce Lyttelton Richmond of Browns Rob County of Sussex Esquire (hereinafter called the Purchaser), of the

Whereas the Vendor is seized for an estate of inheritance absolute in possession free from incumbrances of the property he assumed and has agreed to sell the same for a like estate to the P of Three hundred and ten pounds **Now** this Deed witnes

1. In pursuance of the said agreement and in consideration Three hundred and ten pounds paid by the Purchaser receipt whereof the Vendor hereby acknowledges) the Vendor as he conveys unto the Purchaser **All** that piece or parcel of land

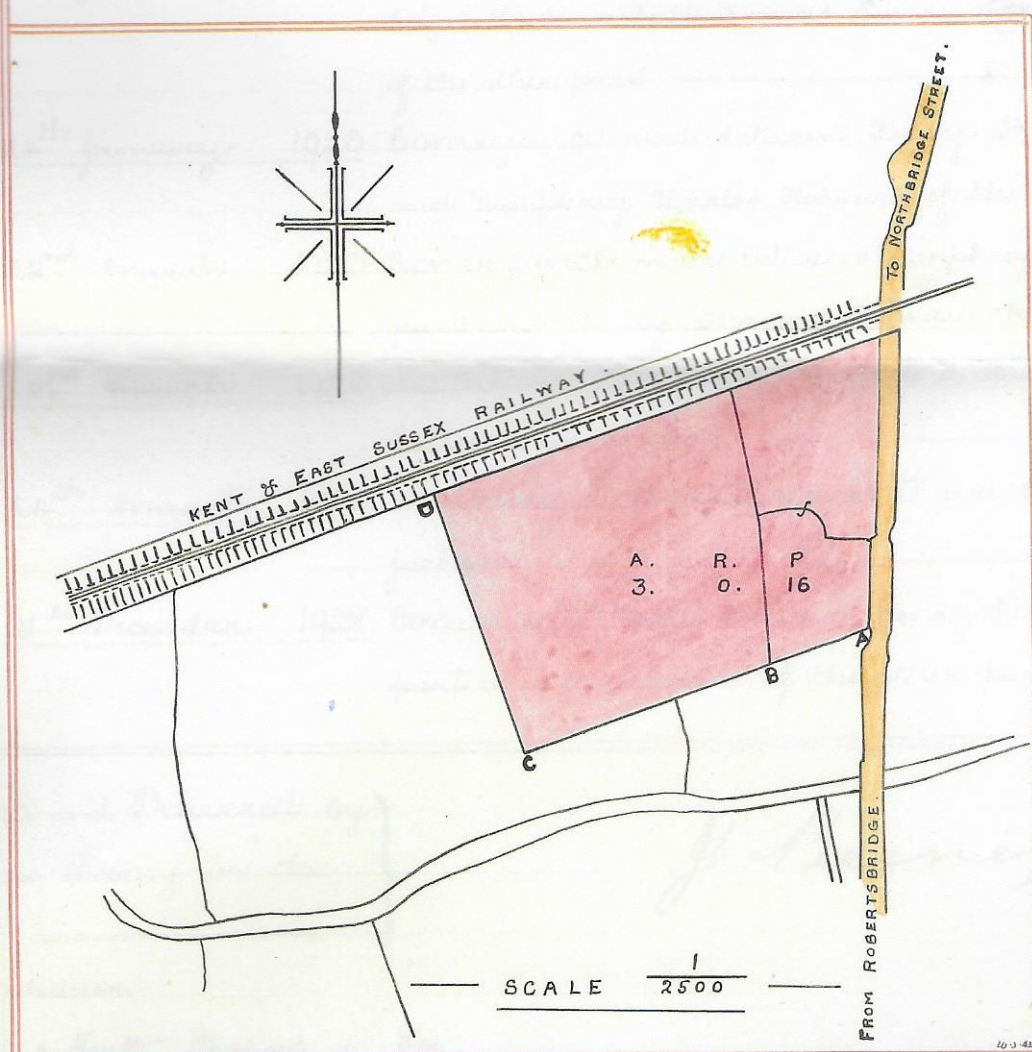

Robertson Parish of County of side of an to the mo the High Street an acres are thereabout of land is indentifi on the pa thereon c hold e fee simp 2. Sh piece of and wit

persons in whom the same shall for the time being be vested but n cable under this covenant after he has parted with all interest in hereby covenants with the Vendor as follows (1) Within two mont at his own expense and in a proper and workmanlike manner to s for ever thereafter at the like expense maintain and keep in repair boundary fence against horses sheep and cattle along the south sid parcel of land between the points marked "A" and "B" on the sa all times hereafter at his own expense to maintain and keep in repair

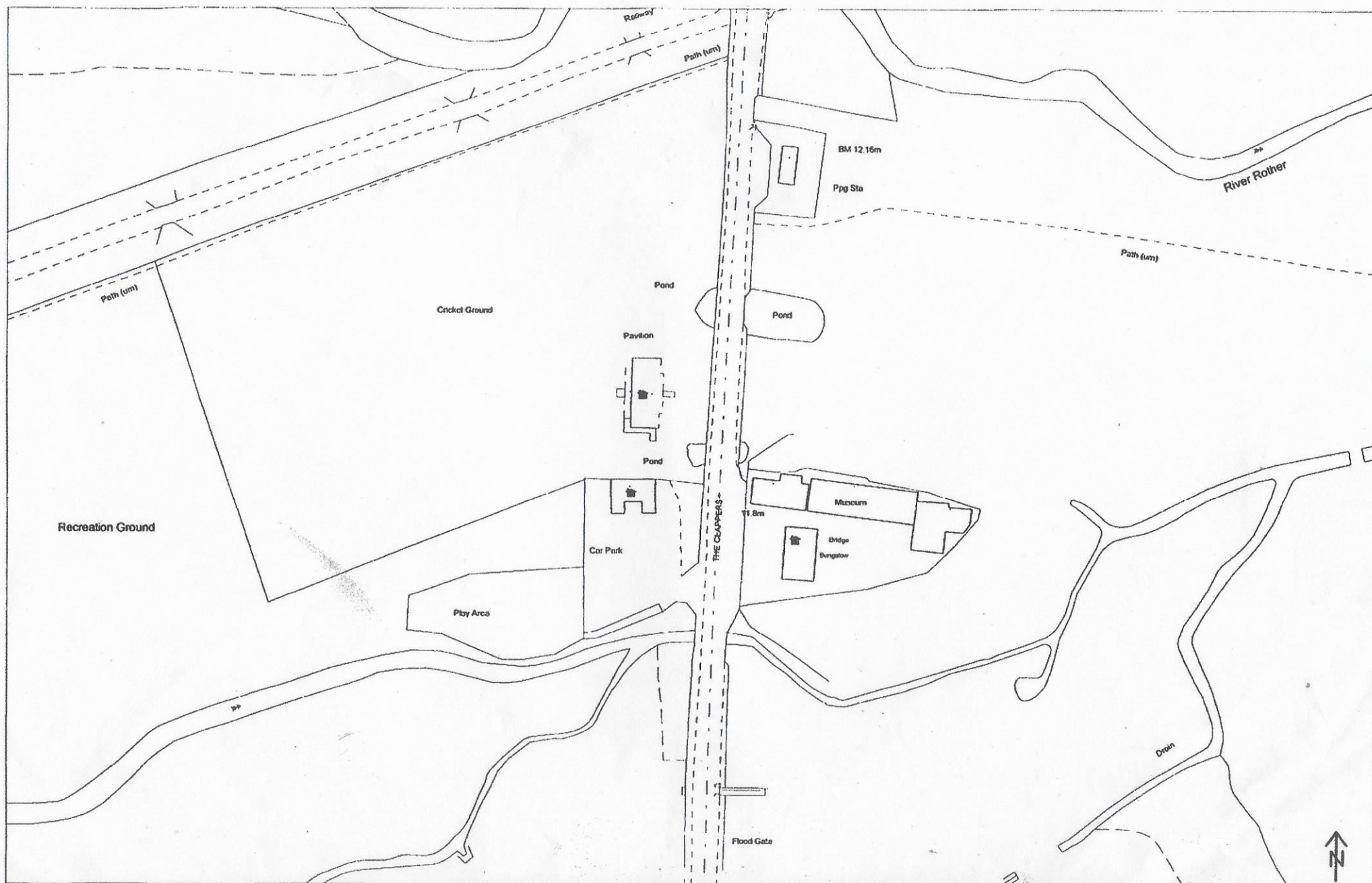

Reproduced from the Ordnance Survey mapping with the permission of the Controller of Her Majesty's Stationery Office.
 (Crown Copyright). Unauthorised reproduction infringes Crown copyright and may lead to prosecution or civil proceedings.
 Rother District Council Licence No 100018643. No further copies may be made.