



REVISION NOTE: Key levels added to all existing drawings.

01
(01) 308

01
(01) 307

01
(01) 306

01
(01) 305

01
(01) 304

01
(01) 302

No.4

No.6

No.8

No.10

No.12

No.14

No.16

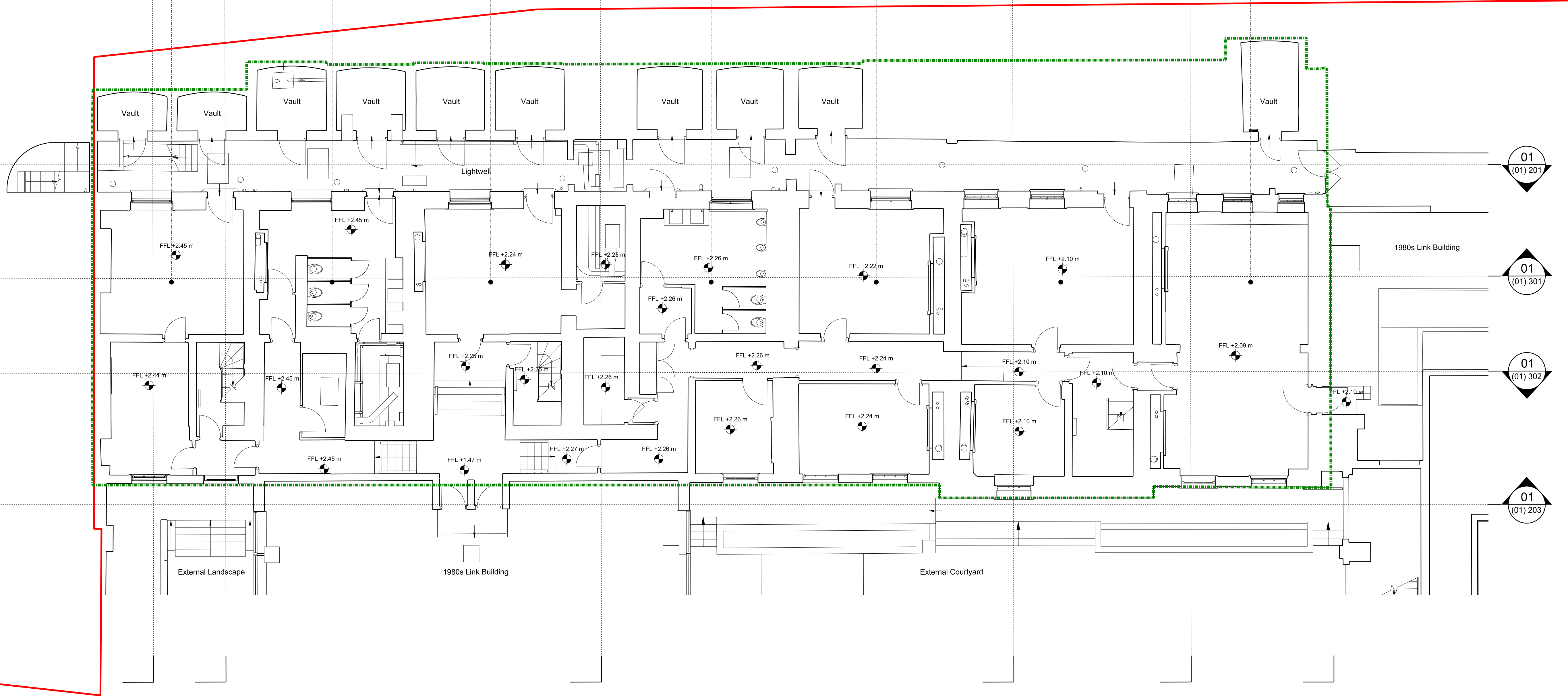

01
(01) 201

01
(01) 301

01
(01) 302

01
(01) 203

01 LOWER GROUND FLOOR PLAN

KEY
— Planning Application Boundary
- - - Listing Building Consent Boundary
NOTE
EXISTING BUILDING INFORMATION TAKEN FROM 2D SURVEY DRAWINGS FROM FLOWMAN GRAVEN.

REV	DATE
P01	06/12/18 Issued for Planning

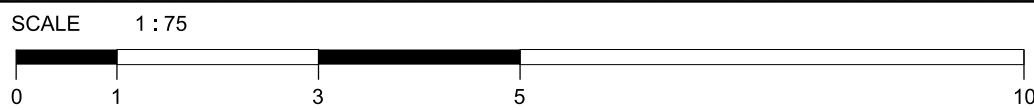

NOTE

1. Do not scale from this drawing.
2. All dimensions to be checked on site by the contractor and such dimensions to be his responsibility.
3. Report all drawing errors, omissions and discrepancies to the architect.
4. This document may be issued in an uncontrolled CAD format to enable others to use it as background information to make alterations and/or additions. In that instance the file will be accompanied by a PDF version. It is for those making such alterations and additions to ensure that they make use of current background information.

AHMM Ltd accepts no liability for any such alterations or additions to the background information or arising out of changes to background information which occur prior to alterations or additions being made.

LOCATION

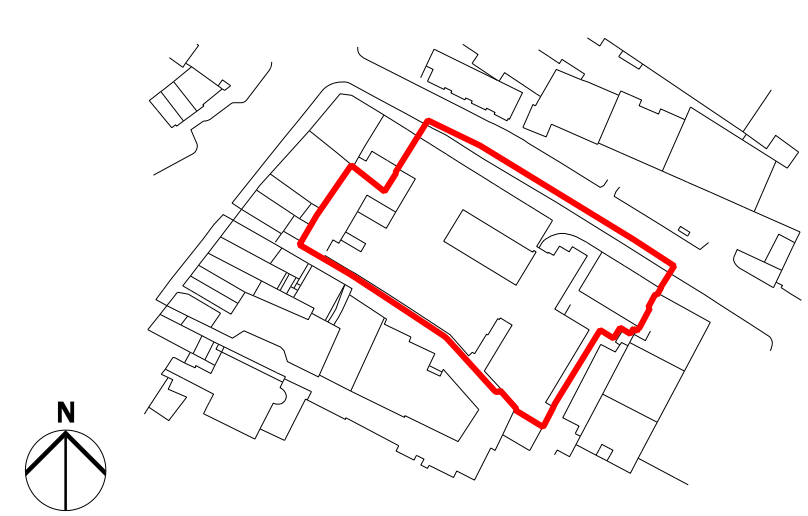

ALLFORD HALL MONAGHAN MORRIS						
ARCHITECTS Ltd 2ND FLOOR, BLOCK C, 5-23 OLD STREET LONDON EC1V 9HL TEL 020 7251 5261 FAX 020 7251 5123 WEB WWW.AHMM.CO.UK						
job title						
NEW CITY COURT						
drawing title / location						
GEORGIAN TOWNHOUSES EXISTING LOWER GROUND FLOOR PLAN						
drawn by	checked	scale			status	
JC	HT	1:75@A1; 1:150@A3			PLANNING	
project	zone	type	classification	drawing no	revision	
14032	G	-	(01)	P119	P01	