

Figure 3-7: Built heritage assets with Zone of Visual Influence and gazetteer

Approximate Site boundary marked in red for indicative purposes only. An approximate 1km radius is marked on the map.

Borough boundaries are marked with a light grey dotted line.

Areas from which any part of the Development has the potential to be seen (see Appendix A for Millerhare methodology)

World Heritage Site: Tower of London

Listed buildings:

Grade I listed building  
Grade II\* listed building  
Grade II listed building

Scheduled monuments (no dual status as LB's)  
Non designated heritage assets (locally listed buildings)  
Other non designated heritage assets

Conservation areas

- 1 Borough High Street Conservation Area (LBS)
- 2 Tooley Street Conservation Area (LBS)
- 3 Bear Gardens Conservation Area (LBS)
- 4 Thrale Street Conservation Area (LBS)
- 5 Union Street Conservation Area (LBS)
- 6 Liberty of the Mint Conservation Area (LBS)
- 7 King's Bench Conservation Area (LBS)
- 8 Trinity Church Square Conservation Area (LBS)
- 9 Bermondsey Street Conservation Area (LBS)
- 10 Tower Bridge Conservation Area (LBS)
- 11 The Tower Conservation Area (LBTH)
- 12 Leadenhall Market Conservation Area (CoL)
- 13 Whitefriars Conservation Area (CoL)
- 14 St George's Circus Conservation Area (LBS)
- 15 Bank Conservation Area (CoL)



**Listed Building groups (those with dual status as SM are indicated by):**

- Group (i) - The Site
- Group (ii) - Montague Close / Clink Street (grade II)
- Group (iii) - St Thomas Street (grade II\*)
- Group (iv) - St Thomas Street (grade II)
- Group (v) - Guy’s Hospital (grade II)
- Group (vi) - Borough High Street, north end (grade II)
- Group (vii) - Southwark Street, east end and streets to the north (grade II)
- Group (viii) - Borough Market (grade II)
- Group (ix) - London Bridge Station (grade II)
- Group (x) - Tooley Street, north-west end (grade II)
- Group (xi) - Tooley Street, central (grade II)
- Group (xii) - Fair Street/Tooley Street, south-east end (grade II)
- Group (xiii) - Tower Bridge Road and riverside (grade II)
- Group (xiv) - Streets east of Tower Bridge Road (grade II)
- Group (xv) - Bermondsey Street, north / Brunswick Court and environs (grade II)
- Group (xvi) - Bermondsey Street, south / Leathermarket (grade II)
- Group (xvii) - Tower Bridge Road, south / Long Lane east (grade II)
- Group (xviii) - New Kent Road / Harper Road and environs (grade II)
- Group (xix) - Trinity Street / Newington Causeway (grade II)
- Group (xx) - Borough Road / Lancaster Street (grade II)
- Group (xxi) - Borough High Street, south end and environs (grade II)
- Group (xxii) - Southwark Bridge Road, south end and environs (grade II)
- Group (xxiii) - Southwark Street, west end and environs (grade II)
- Group (xxiv) - Southwark Street, west end and environs (grade II\*)
- Group (xxv) - Bankside (grade II)
- Group (xxvi) - Southwark Bridge (grade II)
- Group (xxvii) - Blackfriars Bridge and environs (grade II)
- Group (xxviii) - Upper Thames Street (grade II)
- Group (xxix) - Lower Thames Street (grade II)
- Group (xxx) - Gracechurch Street and environs (grade II)
- Group (xxxi) - Byward Street / Tower Hill Terrace (grade II)
- Group (xxxii) - Royal Mint (grade II)
- Group (xxxiii) - St Katharine’s Dock (grade II)
- Group (xxxiv) - St Katharine’s Way (grade II)
- Group (xxxv) - Tower Bridge Road (grade I)
- Group (xxxvi) - Tower of London WHS Listed Buildings (grades I, II\* and II)

**Scheduled monument groups (no dual status as LBs)**

- Group (xxxvii) - Queenhithe

**Locally listed building groups**

- Group (xxxviii) – Treveris Street
- Group (xxxix) – Borough Road / Newington Causeway
- Group (xl) – Harper Road / Newington Causeway / New Kent Road

**Individual Listed Buildings (those with dual status as SM are indicated by#):**

- A: Cathedral Church of St Saviour and St Mary Overie (Southwark Cathedral), Cathedral Street (grade I)
- B#: Remains of Winchester Palace, Clink Street (grade II\*)
- C: Guy’s Hospital main building including wings and chapel, St Thomas Street (grade II\*)
- D: The George Inn, no.77 Borough High Street (grade I)
- E: St Saviours Southwark War Memorial, Borough High Street (grade II\*)
- F: St Olaf House, no.13 Tooley Street (grade II\*)
- G: Church of St Mary Magdalene, Bermondsey Street (grade II\*)
- H: No.142 and attached railings, Long Lane (grade II\*)
- I: Church of St George the Martyr, Borough High Street (grade II\*)
- J: Kirkaldy’s testing works and testing machine, no.99 Southwark Street (grade II\*)
- K: Church of St Benet, Paul’s Wharf, Upper Thames Street (grade I)
- L: Vintners Hall, Upper Thames Street (grade I)
- M#: Fishmongers’ Hall, London Bridge (grade II\*)
- N: Church of St Magnus the Martyr, Lower Thames Street (grade I)
- O: Custom House, Lower Thames Street (grade I)
- P: River wall, stairs and cranes, Custom House Quay (grade II\*)
- Q: The Monument, Monument Street (grade I)
- R: Leadenhall Market with subsidiary numbering, Gracechurch Street (grade II\*)
- S: Church of St Peter, Cornhill (grade I)
- T: Church of All Hallows by the Tower, Byward Street, Great Tower Street, Tower Hill (grade I)
- U: The Merchant Navy Memorial, Second World War section, Trinity Square (grade II\*)
- V: The Merchant Navy Memorial, First World War section, Trinity Square Gardens, Trinity Square, Tower Hill (grade I)
- W#: Portion of Old London Wall, Trinity Square, Tower Hill (grade I)
- X: Royal Mint, Tower Hill (grade II\*)
- Y: Cathedral Church of St Paul (grade I)

**Listed Building groups:**

**Group (i) - The Site**

- Nos. 4-8 and 12-16 St Thomas Street and attached railings

**Group (ii) - Montague Close / Clink Street (grade II)**

- Winchester Wharf, Clink Street
- Archway beneath southern end of London Bridge, crossing Tooley Street
- Hibernia Chambers, no. 2 Borough High Street
- Bridge House, no. 4 Borough High Street
- Nos. 6, 8 and 10 Borough High Street
- Bollard at the north east corner of Winchester Square
- Post at north end where street divides on east side of left fork
- Bollard at the corner with Winchester Walk

**Group (iii) - St Thomas Street (grade II\*)**

- No. 9A St Thomas Street
- No. 9 St Thomas Street and attached railings
- Mary Sheridan House (part) and area railings, nos. 11 and 13 St Thomas Street

**Group (iv) - St Thomas Street (grade II)**

- Bunch of Grapes Public House, no. 2 St Thomas Street
- Mary Sheridan House (part) and attached area railings, no.15 St Thomas Street
- K2 Telephone kiosk outside nos.17 and 19 St Thomas Street

**Group (v) - Guy’s Hospital (grade II)**

- Gates, gate piers and street railings to Guy’s Hospital
- Statue of Thomas Guy in courtyard of Guy’s Hospital, including pedestal and railings
- Alcove from old London Bridge in the inner quadrangle of Guy’s Hospital
- Guy’s Hospital War Memorial

**Group (vi) - Borough High Street, north end (grade II)**

- Post Office, no. 19A Borough High Street
- Post at north corner of Bedale Street
- No. 28 Borough High Street
- No. 1B Southwark Street
- No. 30 Borough High Street
- Nos. 32 and 34 Borough High Street
- No. 3 Southwark Street
- No. 38 Borough High Street
- No. 40 Borough High Street
- Kings Head Public House, Kings Head Yard, including no. 45 Borough High Street
- Nos. 50 and 52 Borough High Street
- Calverts Buildings (attached to rear of no. 50 Borough High Street)
- No. 52A Borough High Street
- Nos. 53 and 53A Borough High Street
- No. 54 Borough High Street
- No. 55 Borough High Street
- No. 58 Borough High Street
- No. 67 Borough High Street
- Nos. 66, 68 and 70 Borough High Street
- No. 91 Borough High Street

- Nos. 93 and 95 Borough High Street
- No. 101 Borough High Street
- Two posts at north and south entrances to Newcomen Street
- No. 103 Borough High Street
- The Grapes Public House, no. 121 Borough High Street
- Nos. 123, 125 and 127 Borough High Street

**Group (vii) - Southwark Street, east end and streets to the north (grade II)**

- The Hop Exchange, no.24 Southwark Street
- No. 49 Southwark Street
- Nos. 51 and 53 Southwark Street
- Nos. 55-59 Thrale Street
- Cromwell Buildings nos. 5-24 and attached railings, Redcross Way
- Nos.21 and 23 Park Street and attached railings
- Nos.20-26 Park Street
- Posts in front of no. 21 and no. 23

**Group (viii) - Borough Market (grade II)**

- Cannon bollard between no. 1 and no. 2
- Re-sited Floral Hall Portico at Borough Market
- The Globe Public House, Bedale Street
- Six bollards to entrance of Green Dragon Court and three bollards and one lamp post to rear of the Globe Public House
- No.5 Stoney Street
- The Wheatsheaf Public House, no.6 Stoney Street
- Nos.1-11 Park Street
- No.13 Park Street

**Group (ix) - London Bridge Station (grade II)**

- Railway viaduct arches, Crucifix Lane
- Bridge over north end, London Bridge Station

**Group (x) - Tooley Street, north-west end (grade II)**

- Denmark House, no. 15 Tooley Street
- London Bridge Hospital, the riverside block behind Tooley Street
- London Bridge Hospital (part), nos. 17-25 Tooley Street
- Nos. 29, 31 and 33 Tooley Street
- Nos. 47 and 49 Tooley Street
- Hays Galleria, Counter Street
- The Counting House, nos. 51-67 Tooley Street

**Group (xi) - Tooley Street, central (grade II)**

- Shipwrights Arms Public House, no. 88 Tooley Street
- Nos. 115-121 Tooley Street
- Fire Station, nos.139 and 141 Tooley Street

**Group (xii) - Fair Street/Tooley Street, south-east end (grade II)**

- Three bollards, Potters Field
- South London College, Tooley Street
- Statue on island site in front of South London College and railings, Tooley Street
- No. 201 (former London and County Bank), Tooley Street
- Watch House in St John's Churchyard (Recreation Ground), Fair Street
- Gate piers and railings to Churchyard of former Church of St John
- No.10 and attached railings to front door steps, Fair Street
- War Memorial, Fair Street

**Group (xiii) - Tower Bridge Road and riverside (grade II)**

- Tower Bridge Bridgemaster's House (Bridge House Estate) and gate to side, Tower Bridge Road (West side)
- Accumulator Tower and chimney stack to east side of Tower Bridge Approach, Tower Bridge Road
- Horseleydown old stairs and hard, Shad Thames
- Butler's Wharf Building (No.36 Shad Thames) and Butler's Wharf West (Nos.38-42 (even) Shad Thames)

**Group (xiv) - Streets east of Tower Bridge Road (grade II)**

- The Anchor Tap Public House, Copper Row, Horselydown Lane
- Eagle Wharf, 59 Lafone Street, Shad Thames
- Tower Bridge Magistrates Court and Police Station and attached railings, 209 and 211 Tooley Street
- The Circle, Queen Elizabeth Street

**Group (xv) - Bermondsey Street, north / Brunswick Court and environs (grade II)**

- No.173 Bermondsey Street
- Drinking Fountain in south east corner of Tanner Street Recreation Ground, Tanner Street
- No.132 Bermondsey Street
- Nos.124-130 (Even) Bermondsey Street
- No.78 Bermondsey Street
- Nos.68-76 (Even) Bermondsey Street
- Nos.59, 61 and 63 and attached railings, Bermondsey Street
- No.55 Bermondsey Street
- Nos. 2 and 4 Leathermarket Street
- K2 Telephone Kiosk at junction with Roper Lane, Tower Bridge Road
- Warehouse, Sarson's Vinegar Factory, Roper Lane
- Bonded warehouse, Sarson's Vinegar Factory, Roper Lane
- Former Still House, Sarson's Vinegar Factory, Roper Lane
- Plumber's office, Sarson's Vinegar Factory, Roper Lane
- Engine House, Boiler House and Coal Store, Sarson's Vinegar Factory, Roper Lane.
- Brewhouse, Sarson's Vinegar Factory, Roper Lane
- Malt Store, Sarson's Vinegar Factory, Roper Lane
- Fermentation Vats, Sarson's Vinegar Factory, Roper Lane

**Group (xvi) - Bermondsey Street, south / Leathermarket (grade II)**

- Gates and gate piers at north east entrance to St Mary's Churchyard, Bermondsey Street
- Watch house in St Mary's Churchyard (Recreation Ground), Bermondsey Street
- Drinking fountain, approx 45m south south-east of Church of St Mary Magdalene, Bermondsey Street
- Chest Tomb, approximately 60 metres south of Church of St Mary Magdalene, near Abbey Street, Bermondsey Street
- Dedication steele approximately 35 metres south of Church of St Mary Magdalene, Bermondsey Street
- Harrison Family Chest Tomb, south of Church of St Mary Magdalene, Bermondsey Street
- Table Tomb in St Mary's Churchyard, near entrance from Bermondsey Street, Bermondsey Street
- Tomb approximately 15 metres south south east of Church of St Mary Magdalene, Bermondsey Street
- Tomb of John Sargeant at south west corner of St Mary Magdalene, Bermondsey Street.

- No.191 Bermondsey Street
- Nos. 187 and 189 Bermondsey Street
- Leather Market, Weston Street
- London Leather, Hide and Wool Exchange, Weston Street, the Jugglers Arms Public House, nos.15 and 17 Leathermarket Street
- Warehouse Block to east of Leathermarket Yard, Units 13-16, Weston Street
- Units 7 and 8, Bermondsey Leather Market, Weston Street
- No.8A, Leathermarket Yard, Weston Street

**Group (xvii) - Tower Bridge Road, south / Long Lane east (grade II)**

- Manze's Eel, Pie and Mash Shop, no. 87 Tower Bridge Road
- Nos.2-5 (Consecutive) and attached railings, Bermondsey Square
- Simon the Tanner Public House, no. 231 Long Lane
- Wall of recreation ground, Long Lane

**Group (xviii) - New Kent Road / Harper Road and environs (grade II)**

- The Star and Cross Church, Falmouth Road
- Joseph Lancaster Primary School, Harper Road
- Geoffrey Chaucer School, Harper Road
- Nos.1-19 (Odd) including handrail, Bartholomew Street
- Tabard Street Centre (former Tabard Street School), Hunter Close,
- Prioress Street

**Group (xix) - Trinity Street / Newington Causeway (grade II)**

- Inner London Sessions Court, Newington Causeway
- Nos. 2-12 (even) Trinity Street
- Trinity Arms Public House, Swan Street
- No.22 and attached railings, Trinity Street
- Nos.25-47 (Odd) and attached railings, Trinity Street
- Nos.32-42 (Even) and attached railings, Trinity Street
- Nos.1-15 (Consecutive) and attached railings, Trinity Church Square
- Nos.16-22 (Consecutive) and attached railings, Trinity Church Square
- Nos.23-29 (Consecutive) and attached railings, Trinity Church Square
- Nos.30-44 (Consecutive) and attached railings, Trinity Church Square
- Nos.45-68 (Consecutive) and attached railings, Trinity Church Square
- The Henry Wood Hall, including gate piers and railings, Trinity Church Square
- Statue in centre of Trinity Church, Trinity Church Square
- K2 telephone kiosk to north-east of the Henry Wood Hall, Trinity Church Square
- Nos.26 and 28 Cole Street
- K2 telephone kiosk Trinity Street at junction with Greater Dover Street
- The Roebuck Public House, Great Dover Street
- Nos.1-13 (Consecutive) and attached railings, Merrick Square
- Nos. 14, 15 and 16 and attached railings, Merrick Square
- Nos.17, 18 and 19 and attached railings, Merrick Square
- Nos.20-32 (Consecutive) and attached railings, Merrick Square
- Railings to Merrick Square Garden, Merrick Square
- Surrey Dispensary, Falmouth Road
- Nos.4, 10, 12 and 18 and attached railings, Falmouth Road
- Nos.20-40 (Even) and attached railings, Falmouth Road

**Group (xx) - Borough Road / Lancaster Street (grade II)**

- St George the Martyr Library, no.12 Borough Road
- The Duke of York Public House, no.47 Borough Road
- Hanover House, nos.49-60 (Consecutive) Borough Road
- No.62 Borough Road



- Clandon House, Boyfield Street Estate
- Albury House, Boyfield Street Estate
- Merrow House, Rushworth Street Estate
- Ripley House, Rushworth Street Estate
- Chadwick House and attached railings, no.48 Rushworth Street
- The Drapers’ Almshouses, nos.1-5 (Consecutive) Glasshill Street
- No.55 Great Suffolk Street
- The Blackfriars Settlement and attached railings, nos.44-47 (Consecutive) Nelson Square
- Former Sons of Temperance Friendly Society Building, no.176 Blackfriars Road

**Group (xxi) - Borough High Street, south end and environs (grade II)**

- No. 151 Borough High Street
- Kings Arms Public House with refixed coat of arms, no. 65 Newcomen Street
- No. 177 Borough High Street
- Wall forming north boundary of public gardens, formerly St George’s Churchyard
- No. 19 Tabard Street
- Nos. 25 and 27 Crosby Row

**Group (xxii) - Southwark Bridge Road, south end and environs (grade II)**

- Wiltshire House, Maidstone Buildings
- Roman Catholic Church of the Most Precious Blood, Presbytery, forecourt walls and shrine, Redcross Way
- Nos.31-37 Union Street
- Nos. 59 and 61 Union Street
- Nos. 62 and 64 Union Street
- Bishops Hall, no. 8 Ayres Street & George Bell House, no. 8A Ayres Street
- Whitecross Cottages, nos.1-6 Ayres Street
- Redcross Cottages, nos. 1-6 Redcross Way
- Lord Clyde Public House, no. 27 Clennam Street
- The Borough Welsh Congregational Chapel, Southwark Bridge Road
- No. 52 Southwark Bridge Road and attached railings
- Winchester House and attached railings, no.94 (part) Southwark Bridge Road
- Southwark Fire Station, no.94 (part) Southwark Bridge Road
- Gable Cottages and garden railings, nos.9-12, 14 & 15, 17-21, 24-28 (consec) Sudrey Street
- Bollard, Great Guildford Street
- Mosaic roundel at Octavia House, no. 54 Ayres Street
- Two cannon bollards at east corner with Ewer Street
- Cannon bollard at north west corner of Pepper Street

**Group (xxiii) - Southwark Street, west end and environs (grade II)**

- No.89 Southwark Street
- Former Fire Station, no.97 Southwark Street
- No.61 and attached railings and overthrow to gate Hopton Street
- Nos.124 and 126 and attached ironwork, Southwark Street
- Rochester House, Nos.43 and 44 Dolben Street

**Group (xxiv) - Southwark Street, west end and environs (grade II\*)**

- Nos. 1-9 Hopton’s Almshouses (Consec), Hopton Gardens
- Nos. 10 and 11 Hopton’s Almshouses, Hopton Gardens

- Nos. 12-21 Hopton’s Almshouses (Consec), Hopton Gardens

**Group (xxv) - Bankside (grade II)**

- Anchor Public House, no. 1 Bankside / no. 34 Park Street
- Union Works, no.60 Park Street
- Cardinal’s Wharf and railings at door, no.49 Bankside
- Nos.51 and 52 Bankside
- Anchor Terrace and attached railings, nos. 1-15 Southwark Bridge Road
- Four posts along bankside
- Post at west corner of Rose Alley
- Five posts outside and opposite no. 1 Anchor Public House

**Group (xxvi) - Southwark Bridge (grade II)**

- Southwark Bridge (that part in London Borough of Southwark)
- Southwark Bridge (listing separate from that above)

**Group (xxvii) - Blackfriars Bridge and environs (grade II)**

- Blackfriars Bridge
- Southern abutment to former West Blackfriars and St Paul’s Rail Bridge, Blackfriars Road
- K2 Telephone Kiosk, Blackfriars Bridge
- Drinking Fountain on east side of road at north end of Bridge, Blackfriars Bridge
- Statue of Queen Victoria at Approach to Blackfriars Bridge, Victoria Embankment

**Group (xxviii) - Upper Thames Street (grade II)**

- Nos.1 to 4 (Consec) Queen Street Place, including no.69 Upper Thames Street

**Group (xxix) - Lower Thames Street (grade II)**

- Billingsgate Market, Lower Thames Street
- Adelaide House, London Bridge
- Pair of towers at Cannon Street Station western tower to Cannon Street Station, Cannon Street, Cousin Lane
- Eastern tower to Cannon Street Station pair of towers at Cannon Street Station, All Hallows Lane, Cannon Street

**Group (xxx) - Gracechurch Street and environs (grade II)**

- No.2a, Eastcheap
- Nos.39 and 40 (Credit Lyonnais) Lombard Street
- Nos.81 and 82 Gracechurch Street
- Nos. 7 and 9 Gracechurch Street

**Group (xxxi) - Byward Street / Tower Hill Terrace (grade II)**

- Wine Cellars at Nos 8 to 10 (consec) (Premises of Messrs Asher Storey) Tower Hill
- Nos.8 - 10 Tower Hill
- Railing and dwarf wall to Church of All Hallows by the Tower (those sections flanking Great Tower Street and Byward Street)
- HM Tower of London Liberty Boundary Markers
- Railings and dwarf wall to Church of All Hallows (flanking Great Tower Street), Great Tower Street

**Group (xxxii) - Royal Mint (grade II)**

- Entrance Lodges at The Royal Mint, Tower Hill
- Seaman’s Registry, Royal Mint Site
- Cast Iron Lamp Standards in forecourt of The Royal Mint

**Group (xxxiii) - St Katharine’s Dock (grade II)**

- St Katharine’s Dock (Warehouse C) St Katharine’s Way
- Warehouse I, St Katharine’s Way
- Footbridge (between the basin and east dock water areas), St Katharine’s Way
- The Quay walls to basin and east and west docks, St Katharine Docks
- Boundary wall and gate piers to St Katharine Docks, St Katharine’s Way
- Group of 3 bollards at lock between basin and east dock, St Katherine’s Docks
- Group of 3 bollards at lock between west dock and Basin Street, St Katherine’s Dock

**Group (xxxiv) - St Katharine’s Way (grade II)**

- British and foreign wharves (warehouse G), St Katharine’s Way
- Alderman stairs and gate piers, St Katharine’s Way
- Timepiece sculpture, St Katharine Docks
- Dockmaster’s office, St Katharine’s Way
- Group of 12 bollards at entrance lock to St Katherine’s Dock’s

**Group (xxxv) - Tower Bridge Road (grade I)**

- Tower Bridge (that part that lies within the Borough of Southwark), Tower Bridge Road
- Tower Bridge (that part in London Borough of Tower Hamlets)
- Tower Bridge approach

**Group (xxxvi) - Tower of London WHS Listed Buildings (grades I, II\* and II)**

- The White Tower (grade I)
- The Middle Tower, with causeway to Byward Tower (QV) and remains of causeway to Lion Tower to west (grade I)
- Chapel of St Peter-ad-Vincula (grade I)
- Inner Curtain Wall, with mural towers, the new armouries, the Queen’s House & nos. 1, 2, 4, 5 and 7 Tower Green (grade I)
- Outer Curtain Wall with casements and mural towers (grade I)
- Revetment wall to south side of moat, from Tower Bridge Approach to Middle Tower (QV) (grade II\*)
- The Old Hospital Block and raised terrace and railings (grade II\*)
- Former Pump House (grade II)
- Museum of the Royal Fusiliers and attached terrace to front (grade II)
- Waterloo Block (grade II)
- Revetment wall to west and north side of moat, from outwork attached to Middle Tower (QV) to Tower Hill postern (grade II)
- Revetment wall to north side of moat, from Tower Hill postern to Tower Bridge Approach (grade II)
- K6 telephone kiosk outside gateway of Byward Tower (grade II)
- HM Tower of London Liberty Boundary Markers (grade II)
- 8 bollards (on pavement outside main entrance to Tower of London) (grade II)
- Waterloo Block (grade II)
- Tower of London (inner curtain wall with mural towers, the New Armouries, the Queen’s House and Tower Green)



## **Scheduled Monuments (no dual status as LBs)**

- Group (xxxvii) – Queenhithe
- Smiths' Wharf, Queenhithe, City of London
- Queenhithe Dock, Queenhithe, City of London

## **Non-designated heritage assets**

### **Locally Listed Buildings**

#### **Group (xxxviii) – Treveris Street**

- No.36 Treveris Street

#### **Group (xxxix) – Borough Road / Newington Causeway**

- Caxton House, 13-16 Borough Road
- The Bridge House, 29-30 Borough Road
- Murphy House, Borough Road
- 1-15 Hunter House & 16-30 Hunter House, King James Street
- 1-4 Gardiner House, Lancaster Street
- Rail Bridge, Borough Road
- 82 Borough Road
- 83 Borough Road
- Diary House 77-81 Borough Road
- 56-62 Newington Causeway
- 38 Newington Causeway
- 94 Webber Street

#### **Group (xl) – Harper Road / Newington Causeway / New Kent Road**

- 73-75 Newington Causeway
- Devonshire House, Bath House, Trinity House, Bath Terrace
- 81 New Kent Road
- 83 New Kent Road
- King William IV public house, 16 Harper Road
- Rising Sun Public House, 98 Harper Road

### **Other NDHAs**

- Nos.9-17 Vinegar Yard
- Nos.54-56 Ayres Street
- No.8 Stoney Street



Appendix A: Millerhare ZVI study and methodology

---



**New City Court, SE1**  
Zone of Visual Influence  
March 2021

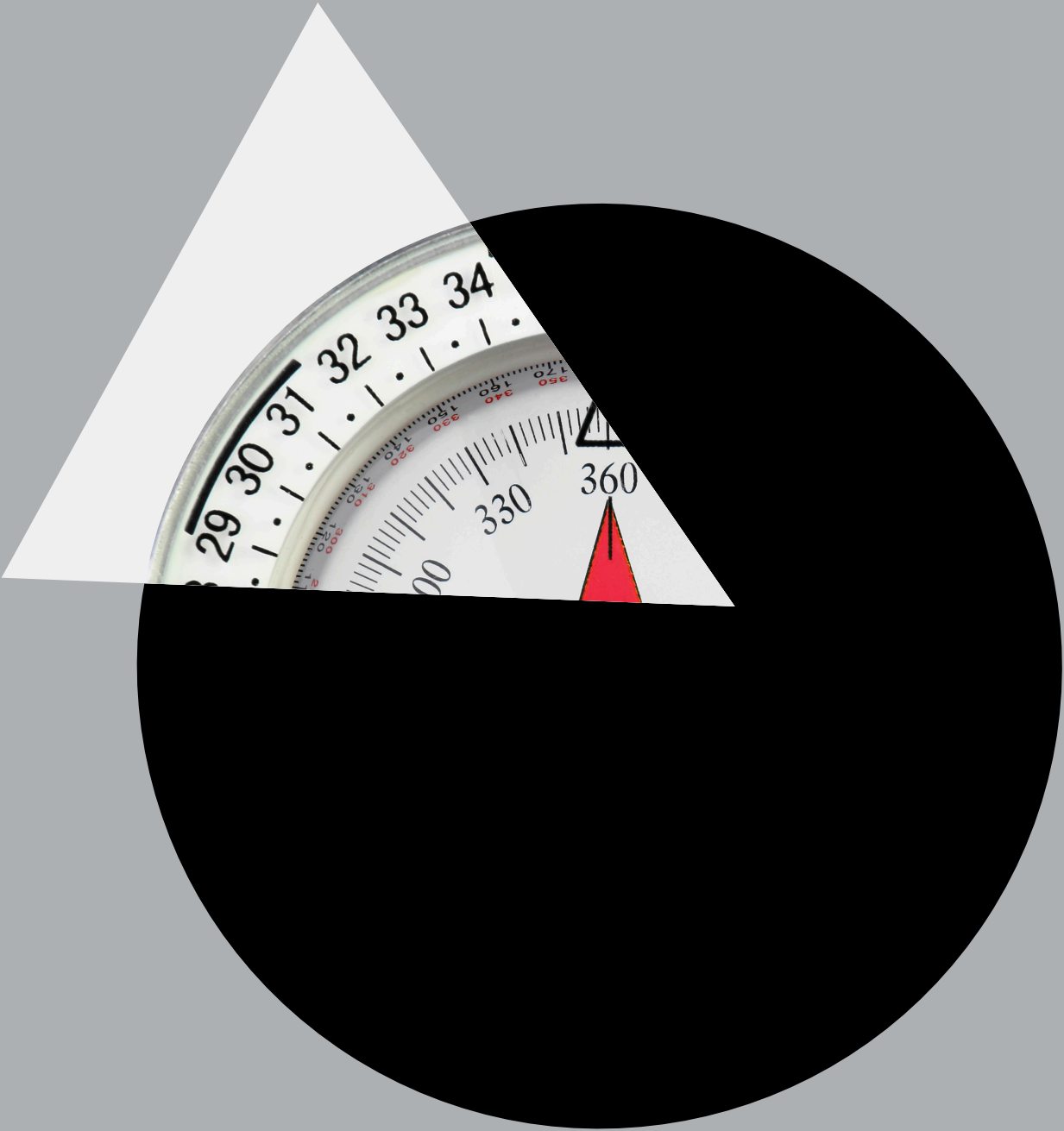



**Miller Hare Limited**  
Mappin House  
4 Winsley Street  
London W1W 8HF

+44 20 7691 1000  
[info@millerhare.com](mailto:info@millerhare.com)

---

New City Court, SE1

Zone of Visual Influence

March 2021

Contents

1	Zone of Visual Influence	2
	Zone of Visual Influence - Proposed Condition	4
	Zone of Visual Influence - Cumulative Condition	5

Client
GPE (St Thomas Street) Limited
Architect
AHMM
Planning Consultant
DP9
Townscape Consultant
Peter Stewart Consultancy
Visualisation
Millerhare



1 Zone of Visual Influence

- 1.1
- This study provides a comparative analysis of the visibility of the proposal at New City Court. The study uses the method of “shadow casting” whereby light sources are placed within a computer model of the proposal and its context. These lights then cast shadows onto the ground plane of the model. From these shadows diagrams of visibility are created.

- 1.2
- This technique does not assess the amount of a development that is visible, only those areas where at least some part of a development is visible.

- 1.3
- Two diagrams have been included: a first showing the visibility of the proposal in the context of existing buildings with a second taking consented and proposed buildings across the study area into account. Proposed townscape viewpoints are indicated on both diagrams (please refern to page 3 for the viewpoint list).

Methodology

- 1.4
- This study is generated using a simple computer model that combines an accurate model of the proposed scheme with a highly simplified model of the surrounding context (with buildings shown to an accuracy of approx +/- 1.5m).
- 1.5
- Into this model a series of light sources are placed at the upper extremities of the scheme being studied.
- 1.6
- From this model a plan view of the study area is generated showing the light sources casting shadows onto a surface raised 1.6m above the normal ground level. Any part of this surface that is exposed to one or more light sources will be shown in a coloured tone, indicating that at least some part of the scheme is visible from this position.
- 1.7
- It should be noted that this method will not produce reliable results where there is a discontinuity in the test surface such as at steps, retaining walls etc.

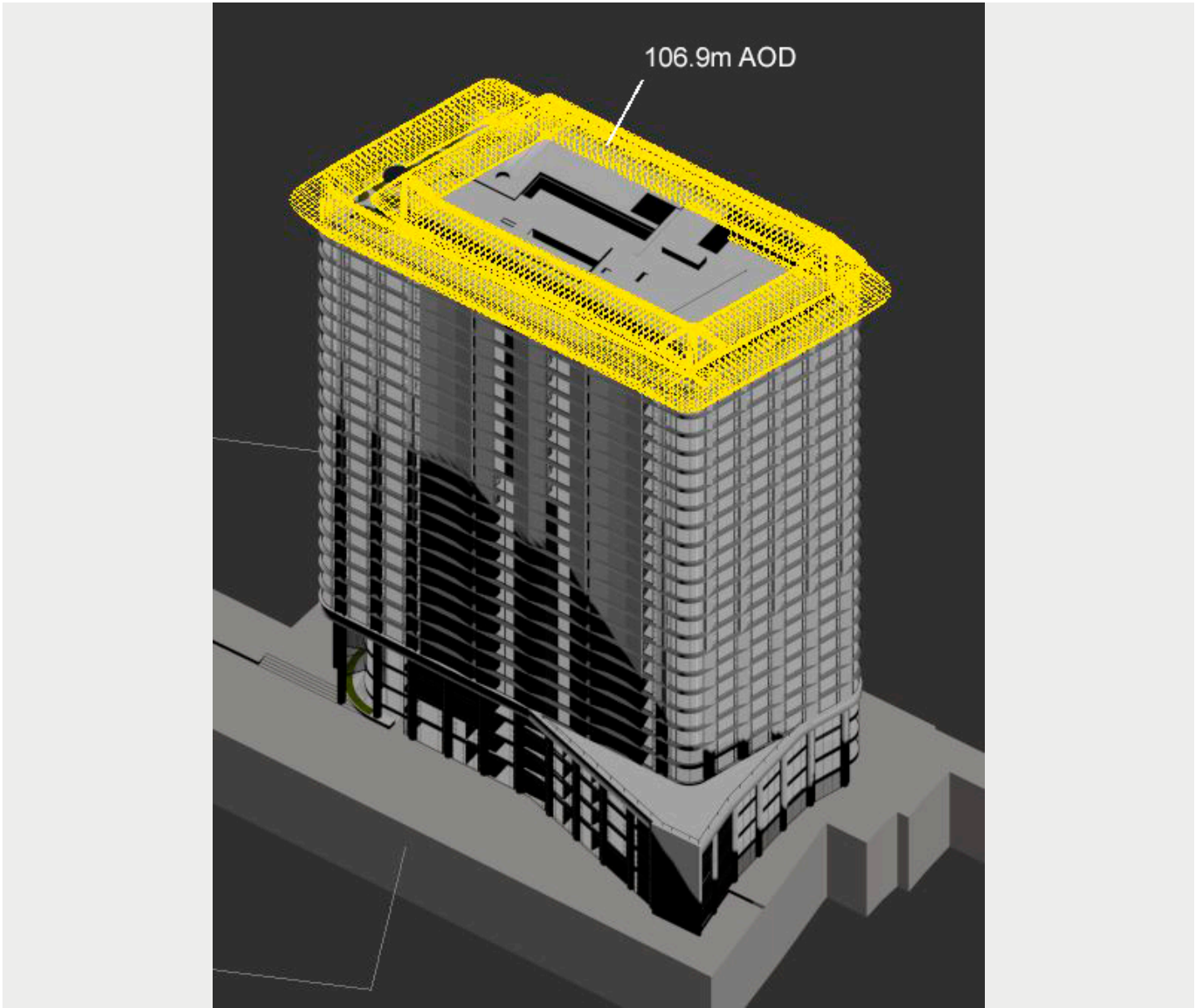
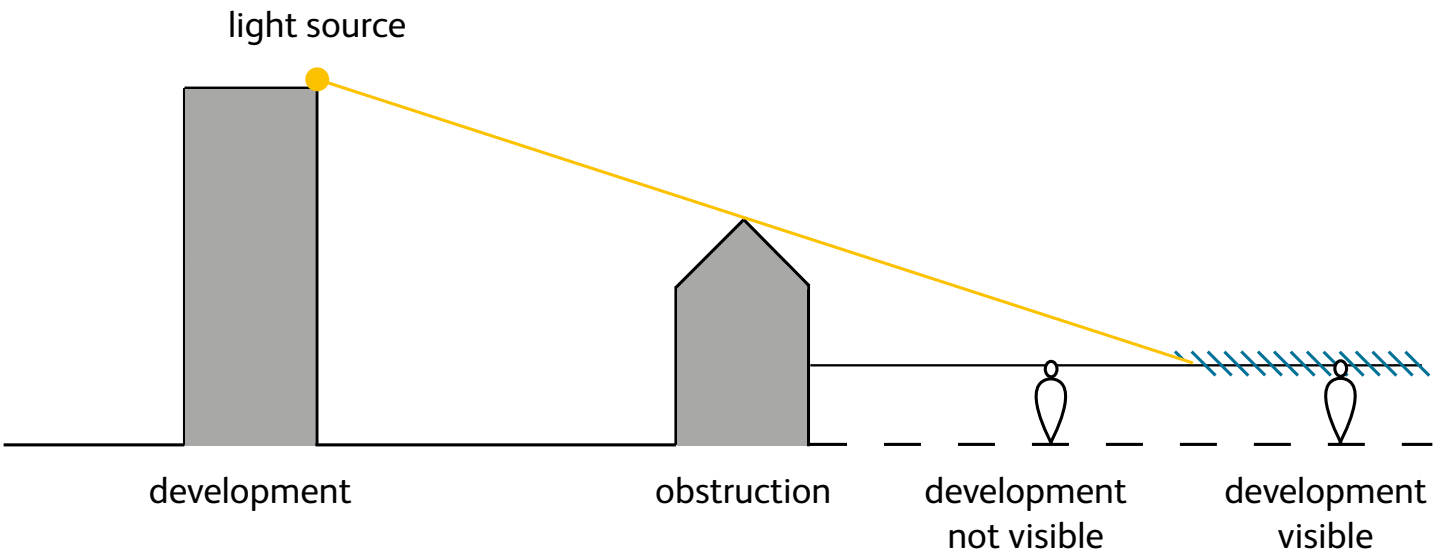

Fig 1: Model Overview (Millerhare ref: swrk0139-b.detail210302-ahmm-proposed

Proposed Townscape Viewpoints

View	Description		
		39	Guy's Hospital: West Wing Quad   Panorama
1	LVMF 1A.1   Alexandra Palace: the viewing terrace - south-western section	40	Guys Courtyard – near the War Memorial
2	LVMF 1A.2   Alexandra Palace: the viewing terrace - approaching from the north-eastern car park	41	Guy's Hospital: North Quad
3	LVMF 2A.1   Parliament Hill: the summit - looking toward St Paul's Cathedral	42	St. Thomas Street / London Bridge Street
3.1	LVMF 2A.1   Parliament Hill: the summit - looking toward St Paul's Cathedral   Telephoto	42	St. Thomas Street / London Bridge Street
4	LVMF 2B.1   Parliament Hill: east of the summit - at the prominent oak tree	43	St. Thomas Street, opposite Guy's Hospital
5	LVMF 3A.1   Kenwood: the viewing gazebo - in front of the orientation board	44	St Thomas Street, outside St. Thomas' Church
5.1	LVMF 3A.1   Kenwood: the viewing gazebo - in front of the orientation board   Telephoto	45	Bedale Street / Borough Market
6	LVMF 4A.1   Primrose Hill: the summit - looking towards St Paul's Cathedral	46	Borough High Street / Bedale Street
7	LVMF 6A.1   Blackheath Point - near the orientation board	47	Cathedral Street / Winchester Walk
8	LBS Borough View 1 - North Facing view from One Tree Hill   Winter	48	Southwark Cathedral   west
8.1	LBS Borough View 1 - North Facing view from One Tree Hill   Winter   telephoto	49	Southwark Cathedral   north-west corner 1
9	LBS Borough View 2 - St Paul's Cathedral from Nunhead Cemetery   Winter	50	Southwark Cathedral   north-west corner 2
9.1	LBS Borough View 2 - St Paul's Cathedral from Nunhead Cemetery   Winter   telephoto	51	Southwark Cathedral   north
10	LVMF 10A.1   Tower Bridge: Upstream - The North Bastion	52	Southwark Cathedral, entrance gates to Millennium Courtyard
11	St Katharine's Dock, at Girl with a Dolphin Fountain	53	Southwark Cathedral: Millennium Courtyard   Panorama
12	LVMF 12B.1   Southwark Bridge: downstream - close to the City of London bank	54	London Bridge, outside Glazier's Hall
13	Millennium Bridge (centre)	55	Islington Local View 1: Clerkenwell Road, bridge across Farringdon
14	LVMF 15B.2   Waterloo Bridge: downstream - at the centre of the bridge	56	Trinity Church Square, south-west corner
15	LVMF 17B.2   Golden Jubilee/Hungerford Footbridges: downstream - close to the Westminster bank		
16	Victoria Embankment, opposite Temple Gardens		
17	Gracechurch Street, corner with Lombard Street		
18	London Bridge: upstream - at the City of London bank		
19	Old Billingsgate Walk		
20	Tower of London: Inner Curtain Wall Walkway		
21	Tower of London: Inner Ward, north of the White Tower		
22	Tower of London Local Setting Study View 1: Tower Green, Inner Ward		
23	Tower of London Local Setting Study View 8: The Royal Mint		
24	Tower Bridge Road / Queen Elizabeth Street		
25	Saint Mary Magdalen Churchyard		
26	Leathermarket Gardens		
27	Tabard Gardens		
28	Borough High Street / Great Suffolk Street		
29	Southwark Bridge Road outside no.92		
30	Red Cross Garden (middle)		
31	Borough High Street / Borough London Underground Station		
32	Borough High Street / Mermaid Court		
33	Southwark Street - east of the railway bridge		
34	Southwark Street / Southwark Bridge Road		
35	Borough High Street, St Saviours Southwark War Memorial		
36	Southwark Street / Stoney Street		
37	King's Head Yard, outside King's Head		
38	George Inn Yard		



Zone of Visual Influence - Proposed Condition



Plan diagram showing areas of visibility.

- Image ref
- 1.8 Plan view created using “shadow casting” technique whereby light sources were placed at the highest points on the proposed development at New City Court and a record made of the areas where this source cast light onto a test surface 1.6m above ground level. A purple tone on the plan indicates areas from which any part of the proposed development is likely to be visible from.
  - 1.9 The proposed building at New City Court is highlighted in yellow on the map.
  - 1.10 The effect of trees has not been taken into consideration.



Southwark Cathedral



Zone of Visual Influence - Cumulative Condition

- 1.11 Plan view created using “shadow casting” technique whereby light sources were placed at the highest points on the proposed development at New City Court and a record made of the areas where this source cast light onto a test surface 1.6m above ground level. A purple tone on the plan indicates areas from which any part of the proposed development is likely to be visible from in the cumulative condition
- 1.12 The proposed building at New City Court is highlighted in yellow on the map
- 1.13 The effect of trees has not been taken into consideration.

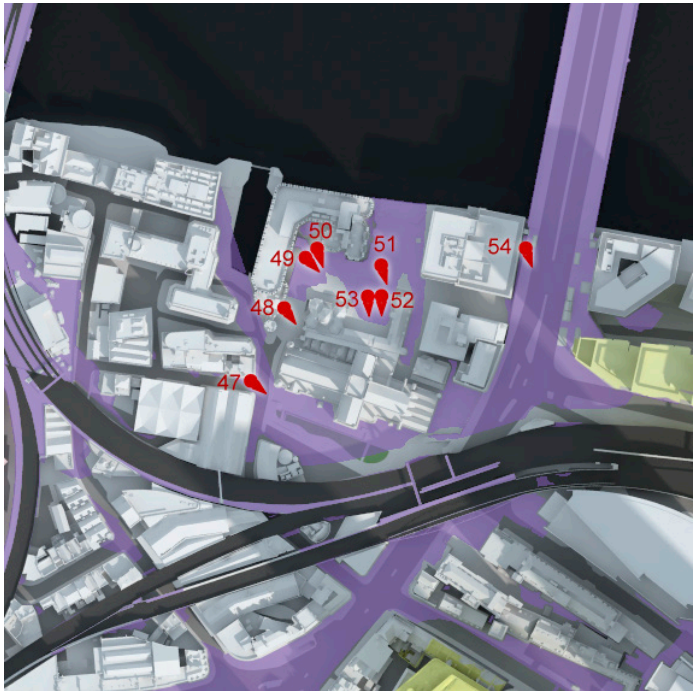

Southwark Cathedral



Plan diagram showing areas of visibility.

Image ref





