

Plot Date: 05 August 2021 15:32  
File Name: C:\Users\NICH\Arden Management Ltd\Arden Management Ltd\Projects - P16 - GIS & CAD Files (15)\P7.1.0 - GISData\ArcPro\060\_ARDG\_TW\_K\_CPO\_r4.aprx

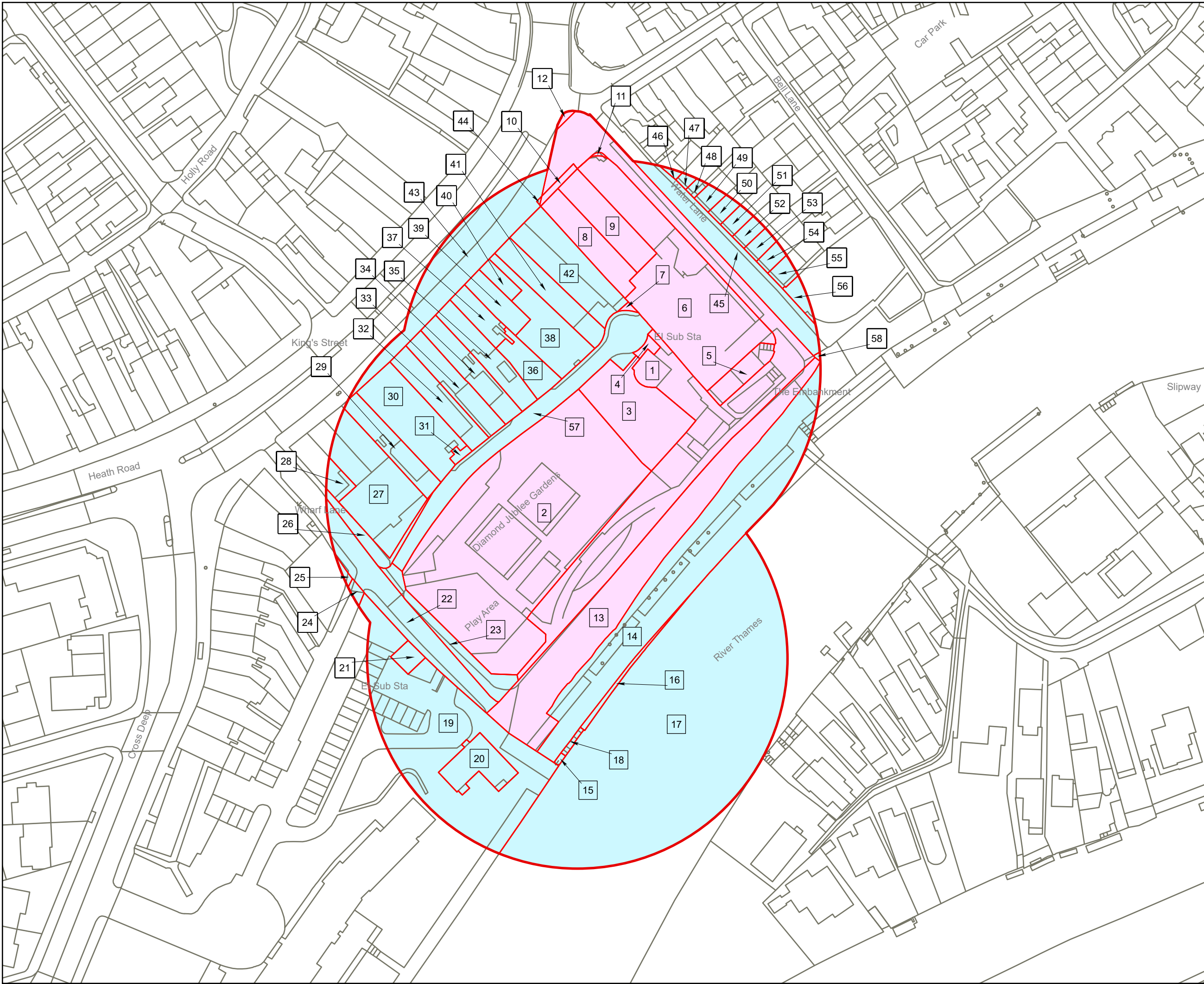

KEY PLAN

Key

Order Boundary

Land to be acquired Permanently

Land required for New Rights

© Crown copyright and database rights 2021 Ordnance Survey 100035409. You are permitted to use this data solely to enable you to respond to, or interact with, the the organisation that provided you with the data. You are not permitted to copy, sub-licence, distribute or sell any of this data to third parties in any form.

© Crown copyright material is reproduced with the permission of Land Registry under delegated authority from the Controller of HMSO.

May contain public sector information licensed under the Open Government Licence v3.0.

Contains OS data © Crown Copyright and database right 2020  
Contains data from OS Zoomstack

Client

LONDON BOROUGH  
OF RICHMOND UPON THAMES

N

Designer

Project

TWICKENHAM RIVERSIDE

Drawing Title

MAP REFERRED TO IN THE LONDON  
BOROUGH OF RICHMOND UPON THAMES  
(TWICKENHAM RIVERSIDE) COMPULSORY  
PURCHASE ORDER 2021

Status

FOR INFORMATION

Revision

004

Scale

1:1,000 @ A3

Spatial Reference System

British National Grid

0 1.5 3 6 9 12 15 18 21 24 27 30 33 36

Metres

Drawn By

N.HENRYS

Checked By

S.KARA

Approved By

A.PAGONIS

Drawing reference

060-ARDG\_TW\_K\_CPO\_r4

This document is not to be used in whole or in part other than for the intended purpose and project for which it was prepared and provided.



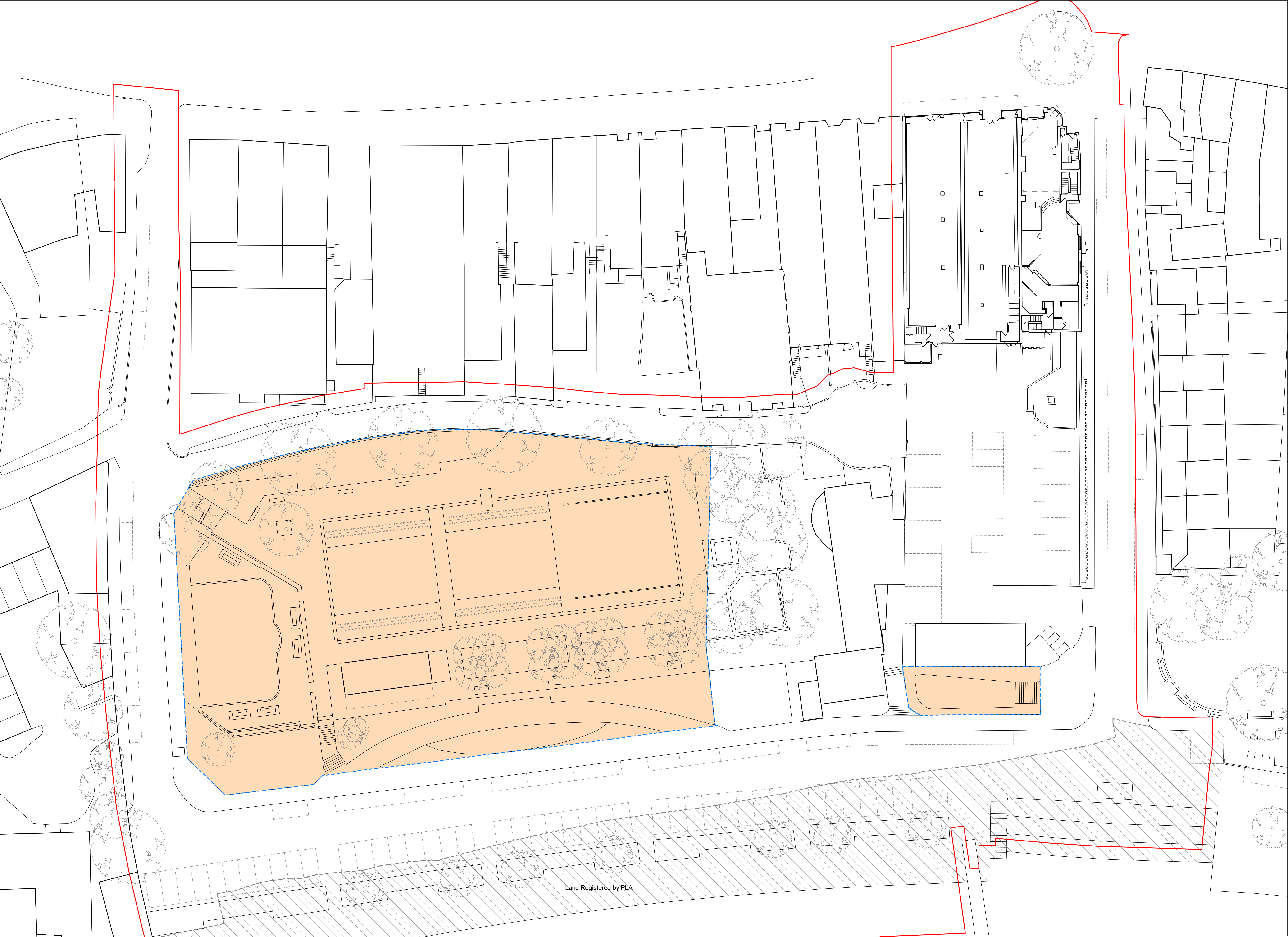

This drawing has been produced for illustrative purposes only and is not based on accurate survey information. The layout is still subject to design development and this is deemed to be acknowledged by all parties if this drawing is used for legal purposes.

Existing locations of buildings, roads, waterways and parkland based on Ordnance Survey data (Stanfords OS MasterMap 28/05/2021) © Crown copyright and database rights 2021 OS Licence 100035409

Existing site levels based on Stanfords Portal LIDAR Height Data DTM Survey Information (13/06/2019) © Crown copyright and database rights 2019 OS Licence 100035409.

Site boundary based on mark-up provided by LBRuT as part of Twickenham Riverside Invitation to Tender document, June 2019. Requires legal verification.

Proposed buildings and landscaping subject to design development, which may affect boundary conditions and areas. Wharf Lane podium edge subject to change.

Landscape design and levels subject to change following further design development.

Boundary of land registered by the PLA on embankment based on Ardent drawing 'Map referred to in the London Borough of Richmond upon Thames (Twickenham Riverside) Compulsory Purchase Order 2021' (drawing reference: 060-ARDG\_TWK\_CPO\_r4)

This drawing is only to be used for the purpose it was provided

Embankment event space shown as Public Open Space as limited traffic through this space will be controlled and managed.

The bounds of Public Open Space to be checked and confirmed by LBRuT before wider distribution

- Key:
- Land Registered by PLA
  - Existing Public Open Space = 3369 sqm

Date	Rev.	Description	Approved By
08/09/2021	P01	M171 - Issue to LBRuT	MB
09/09/2021	P02	M173 - Issue to LBRuT	MB

Date	Rev.	Description	Approved By

DRAFT

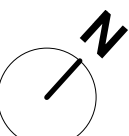

Scale at 1:250

0

2

5

10m

Project	Twickenham Riverside	Code	TRS	File Name	Number	Rev.
Subject	Site Plan - Existing Public Open Space			TRS-HAL-00-00-DR-A-	SK-157	P02
Architects	Hopkins Architects Limited 27 Broadley Terrace, London, NW1 6LG T: 020 7724 1751 E: mail@hopkins.co.uk			Date 09/07/21	Scale 1 : 250	at A1





This drawing has been produced for illustrative purposes only and is not based on accurate survey information. The layout is still subject to design development and this is deemed to be acknowledged by all parties if this drawing is used for legal purposes.

Existing locations of buildings, roads, waterways and parkland based on Ordnance Survey data (Stanfords OS MasterMap 28/05/2021) © Crown copyright and database rights 2021 OS Licence 100035409

Existing site levels based on Stanfords Portal LIDAR Height Data DTM Survey Information (13/06/2019) © Crown copyright and database rights 2019 OS Licence 100035409.

Site boundary based on mark-up provided by LBRuT as part of Twickenham Riverside Invitation to Tender document, June 2019. Requires legal verification.

Proposed buildings and landscaping subject to design development, which may affect boundary conditions and areas. Wharf Lane podium edge subject to change.

Landscape design and levels subject to change following further design development.

Boundary of land registered by the PLA on embankment based on Ardent drawing 'Map referred to in the London Borough of Richmond upon Thames (Twickenham Riverside) Compulsary Purchase Order 2021' (drawing reference: 060-ARDG\_TW\_K\_CPO\_r4)

This drawing is only to be used for the purpose it was provided

Embankment event space shown as Public Open Space as limited traffic through this space will be controlled and managed.

The bounds of Public Open Space to be checked and confirmed by LBRuT before wider distribution

- Key:
- Land Registered by PLA
  - Public Open Space Remaining = 2010 sqm
  - Public Open Space to be Added = 1919 sqm
  - Total Proposed Public Open Space = 3929 sqm**
  - Public Open Space to be Removed = 1359 sqm

Date	Rev.	Description	Approved By	Date	Rev.	Description	Approved By
08/09/2021	P01	M171 - Issue to LBRuT	MB				
09/09/2021	P02	M173 - Issue to LBRuT	MB				

DRAFT

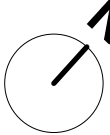

Scale at 1:250  
0 2 5 10m

Project	Twickenham Riverside	Code	TRS	File Name	Number	Rev.
Subject	Site Plan - Proposed Public Open Space			TRS-HAL-00-00-DR-A-	<b>SK-158</b>	<b>P02</b>
Architects	Hopkins Architects Limited 27 Broadley Terrace, London, NW1 6LG T: 020 7724 1751 E: mail@hopkins.co.uk			Date 09/07/21	Scale 1 : 250	at A1