



21 March 2022

Dear Ms Thatcher,

Planning Application 21/2758/FUL

With reference to Document 'Design Access Statement Seating Slide' (3446995.pdf)

The Existing Seating on the Development site has not been accurately represented.

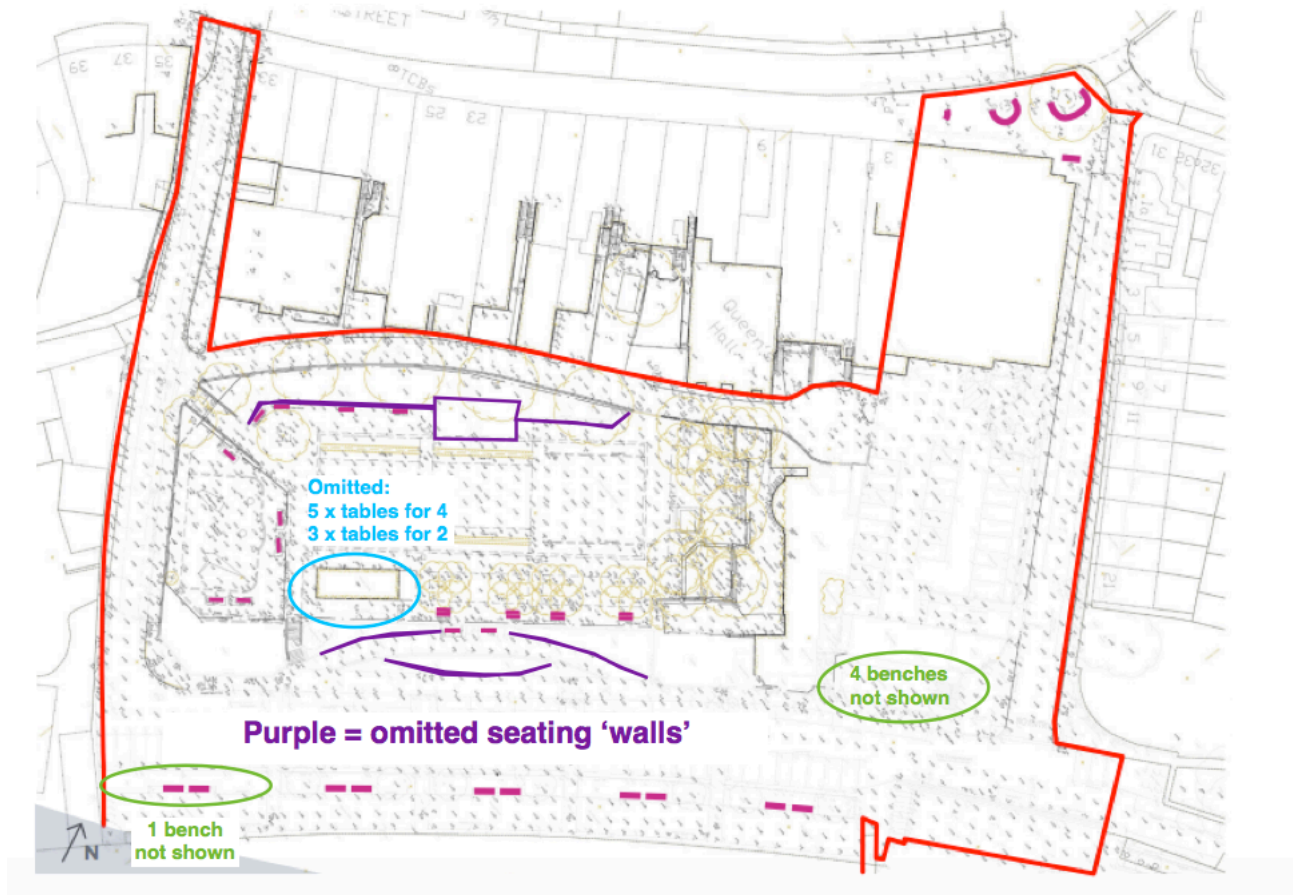

Five benches have been omitted, along with substantial sections of 'seating wall' to include the raised seating area around the edge of the sandpit.

The outdoor seating of Sunshine Cafe has also been omitted - 5 tables that seat 4 people, and 3 tables that seat 2 people.

Marked in purple on the image above (taken from the above referenced slide) are the areas of seating wall/raised seating around sandpit that have been omitted, along with the location of 5 benches (in green) that have also been omitted.

If needed, photographs can be provided of the above seating areas in use if there is any contention that they are not used for seating on a regular basis.

With my best wishes,

Luke Montgomery-Smith
Chair, Twickenham Riverside Trust